

Needle Roller Bearings Shell Type



1.1 Shell Type Needle Roller Bearings

셸 타입 니들 롤러 베어링은 얇은 특수 강판을 정밀 드로잉 가공하여 침탄 담금질 한 셸형 외륜을 사용하고 있으므로, 니들 베어링 중에서 단면 높이가 가장 작고 경량이며 정격하중이 큰 베어링입니다.

이 베어링은 유지기부착형 및 총롤러형이 있으므로 사용조건에 맞춰 선정할 수 있습니다.

유지기부착형은 유지기와 스러스트 링을 사용하여 니들 롤러를 정확하게 안내하는 구조이므로 고속 회전에 적합합니다. 또한 총롤러형은 중하중, 저속 회전에 적합합니다.

설치는 하우징에 대해 압입 고정이므로 축방향의 고정이 필요하지 않아서 경제성이 요구되는 양산품에 적합하여 다양한 용도로 사용되고 있습니다.

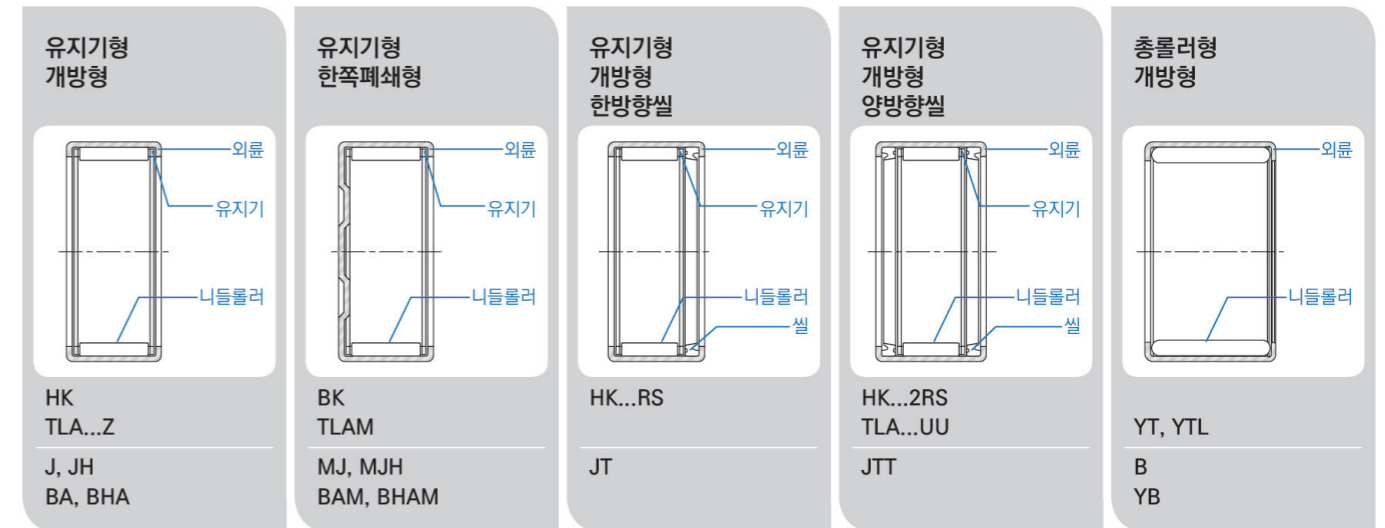

셸타입 유지기형 니들 롤러 베어링

개방형

이 형식은 외륜의 각인측 플랜지 내경과 축의 틈새를 작게 하여 그리스 누출과 이물질 침입을 방지할 수 있는 방진 효과가 있는 베어링으로, 다양한 용도에 사용되고 있습니다.

한쪽폐쇄형

이 형식은 외륜의 한쪽 끝이 완전 밀폐되어 있으므로 축단의 베어링 부 밀폐에 최적의 베어링입니다.

양방향실형

이 베어링은 개방형의 외륜 폭을 넓게 하여 플랜지 안쪽에 보강 링과 특수 합성 고무로 이루어진 실을 조합한 것으로, 그리스의 누출과 이물질 침입을 방지하는 효과가 있습니다.

셸타입 총롤러형 니들 롤러 베어링

이 베어링은 외륜의 궤도 폭 전면에 걸쳐 롤러가 접촉한 총 롤러이므로 큰 베어링 하중을 견디며, 저속, 중속 회전 및 요동운동을 사용하는 장소에 적합합니다. 또한 롤러를 유지하기 위해 윤활 그리스가 봉입되어 있으므로 설치 후 그대로 운전할 수 있습니다.

여러 개의 조합

개방형 셸 타입 니들 롤러 베어링을 여러 개 조합 사용할 경우 균일한 하중 분포가 이루어지도록 베어링 지름이 동일하여야 합니다.

축 및 하우징의 공차

셸형 니들 베어링은 하우징 구멍에 압입된 후 비로소 정규 치수 정밀도를 얻을 수 있습니다. 두께가 얇은 외륜이므로 베어링 정밀도는 하우징의 치수, 형상 및 강성에 직접적인 영향을 받으므로 주의해야 합니다. 또한 축 및 하우징 구멍에 설치했을 때의 레이디얼 틈새는 베어링, 축 및 하우징 구멍의 각 허용차에 따라 변화합니다. 셸형 니들 베어링의 허용오차는 아래 표와 같습니다.

베어링 형식	하우징 재질	공차		
		축		하우징
		내륜 없음	내륜 부착	
TA, BA, BHA, TAM, BAM, BHAM, YT, YB, YBH	강, 주철	h6	k5 (j5)	J7
	경합금(얇은 강판)	h6	k5 (j5)	M7 (N7)
TLA, TLAM, YTL, TLA...UU	강, 주철	h6	k5 (j5)	N7
	경합금(얇은 강판)	h6	k5 (j5)	R7 (S7)

1.1 Shell Type Needle Roller Bearings

미리계열

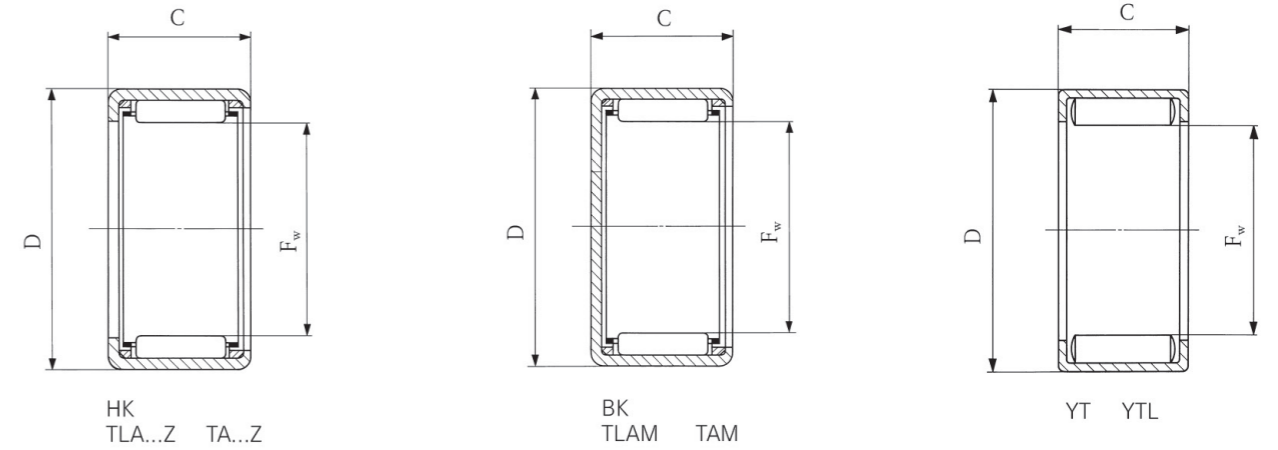

내경 F _w (mm)	외경 D (mm)	폭 C (mm)	유지기형						총롤러형
			Koyo	IKO	IKO	Koyo	IKO	IKO	IKO
			개방형1		개방형2	한쪽폐쇄형1		한쪽폐쇄형2	개방형
3	6.5	6	HK 0306	-	-	-	-	-	-
	6.5	6	-	-	-	BK 0306	-	-	-
4	8	8	HK 0408	TLA 48Z	-	-	TLAM 48	-	-
	8	8	-	-	-	BK 0408	-	-	YTL 48
5	9	9	HK 0509	TLA 59Z	-	-	TLAM 59	-	-
	9	9	-	-	-	-	-	-	YTL 59
6	10	8	HK 0608	-	-	-	-	-	-
	10	9	HK 0609	TLA 69Z	-	-	TLAM 69	-	-
	10	9	-	-	-	BK 0609	-	-	-
7	11	9	HK 0709	TLA 79Z	-	-	TLAM 79	-	-
	11	9	-	-	-	BK 0709	-	-	-
8	12	8	HK 0808	-	-	BK 0808	-	-	-
	12	10	HK 0810	TLA 810Z	-	-	TLAM 810	-	-
	12	10	-	-	-	BK 0810	-	-	-
	15	10	-	-	TA 810Z	-	-	TAM 810	-
	15	10	-	-	-	-	-	-	YT 810
	15	15	-	-	TA 815Z	-	-	TAM 815	-
	15	20	-	-	TA 820Z	-	-	TAM 820	-
9	13	10	HK 0910	TLA 910Z	-	BK 0910	TLAM 910	-	-
	13	12	HK 0912	TLA 912Z	-	BK 0912	TLAM 912	-	-
	16	12	-	-	TA 912Z	-	-	TAM 912	-
	16	12	-	-	-	-	-	-	YT 912
	16	16	-	-	TA 916Z	-	-	TAM 916	-
10	14	10	HK 1010	TLA 1010Z	-	BK 1010	TLAM 1010	-	-
	14	12	HK 1012	TLA 1012Z	-	BK 1012	TLAM 1012	-	-
	14	15	HK 1015	TLA 1015Z	-	BK 1015	TLAM 1015	-	-
	17	10	-	-	TA 1010Z	-	-	TAM 1010	-
	17	12	-	-	TA 1012Z	-	-	TAM 1012	-
	17	15	-	-	TA 1015Z	-	-	TAM 1015	-
	17	20	-	-	TA 1020Z	-	-	TAM 1020	-

사양						적합한 Inner Ring	
동정격하중 C N	Koyo 정정격하중 C ₀ N	허용 회전수 rpm ⁽¹⁾	동정격하중 C N	IKO 정정격하중 C ₀ N	허용 회전수 rpm ⁽¹⁾	Koyo	IKO
1,600	1,140	46,000	-	-	-	-	-
1,200	781	46,000	-	-	-	-	-
1,880	1,380	39,000	1,350	1,010	75,000	-	-
1,830	1,320	39,000	3,010	2,900	40,000	-	-
2,520	2,070	36,000	1,880	1,600	65,000	-	-
-	-	-	4,320	4,750	30,000	-	-
2,340	1,950	33,000	-	-	-	-	-
3,150	2,940	33,000	2,100	1,900	55,000	-	-
3,140	2,850	33,000	-	-	-	-	-
3,220	3,120	32,000	2,490	2,450	50,000	-	-
3,230	3,050	32,000	-	-	-	-	-
2,900	2,730	31,000	-	-	-	-	-
3,950	4,070	31,000	3,320	3,670	45,000	JR 5x8x12	-
3,930	4,140	31,000	-	-	-	-	-
-	-	-	3,470	2,880	45,000	-	-
-	-	-	7,530	7,950	19,000	-	-
-	-	-	5,780	5,570	45,000	-	-
-	-	-	8,340	8,920	45,000	-	-
4,570	5,070	30,000	3,500	4,040	45,000	JR 6x9x12	-
5,650	6,650	30,000	4,460	5,510	45,000	JR 6x9x12	-
-	-	-	5,140	4,880	45,000	-	-
-	-	-	9,690	11,200	17,000	-	-
-	-	-	6,960	7,210	45,000	-	-
4,780	5,510	29,000	3,870	4,740	40,000	JR 7x10x10.5	IRT 710
5,900	7,230	29,000	4,920	6,460	40,000	JR 7x10x12	IRT 712
7,490	9,810	29,000	6,390	9,040	40,000	JR 7x10x16	IRT 715
-	-	-	4,150	3,780	40,000	-	IRT 710
-	-	-	5,590	5,540	40,000	-	IRT 712
-	-	-	6,920	7,300	40,000	-	IRT 715
-	-	-	9,990	11,700	40,000	-	-

(1) HK..RS, HK..2RS, TLA..UU는 그리스 주입시 허용회전수이며, 그 외에는 오일주입시 허용회전수입니다.

1.1 Shell Type Needle Roller Bearings

미리계열

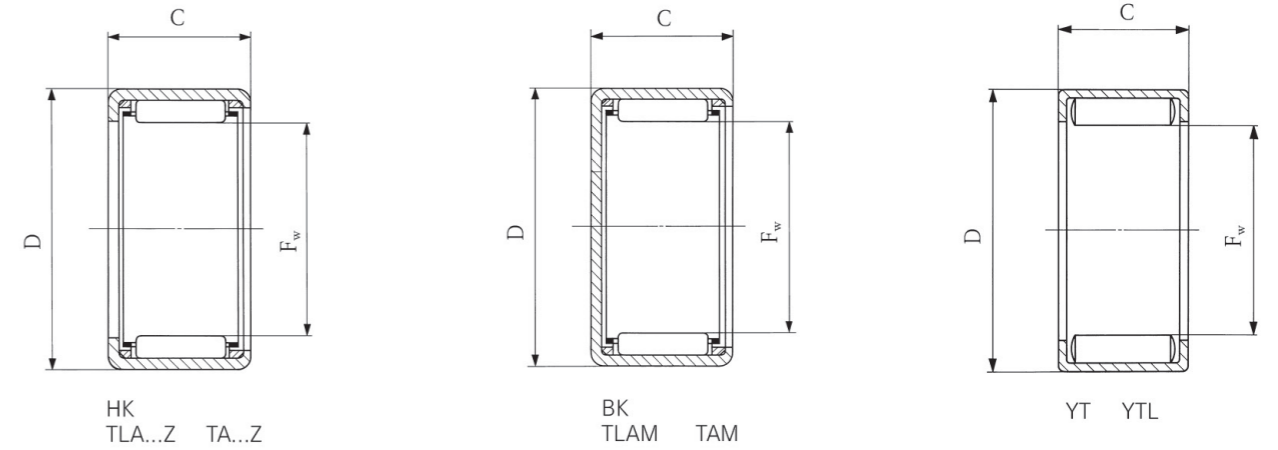

내경 F _w (mm)	외경 D (mm)	폭 C (mm)	유지기형						총롤러형
			Koyo	IKO	IKO	Koyo	IKO	IKO	IKO
			개방형1		개방형2	한쪽폐쇄형1		한쪽폐쇄형2	개방형
12	16	10	HK 1210	TLA 1210Z	-	BK 1210	TLAM 1210	-	-
	16	10	-	-	-	-	-	-	YTL 1210
	18	12	HK 1212	TLA 1212Z	-	BK 1212	TLAM 1212	-	-
	18	14	HK 1214RS	-	-	-	-	-	-
	18	16	HK 1216.2RS	TLA 1216UU	-	-	-	-	-
	19	12	-	-	TA 1212Z	-	-	TAM 1212	-
	19	12	-	-	-	-	-	-	YT 1212
	19	15	-	-	TA 1215Z	-	-	TAM 1215	-
	19	20	-	-	TA 1220Z	-	-	TAM 1220	-
	19	25	-	-	TA 1225Z	-	-	TAM 1225	-
13	19	12	HK 1312	TLA 1312Z	-	BK 1312	TLAM 1312	-	-
14	20	12	HK 1412	TLA 1412Z	-	BK 1412	TLAM 1412	-	-
	20	14	HK 1414RS	-	-	-	-	-	-
	20	16	-	TLA 1416Z	-	-	TLAM 1416	-	-
	20	16	HK 1416.2RS	TLA 1416UU	-	-	-	-	-
	22	16	-	-	TA 1416Z	-	-	TAM 1416	-
	22	20	-	-	TA 1420Z	-	-	TAM 1420	-
15	21	12	HK 1512	TLA 1512Z	-	-	TLAM 1512	-	-
	21	12	-	-	-	BK 1512	-	-	-
	21	14	HK 1514RS	-	-	-	-	-	-
	21	16	HK 1516	TLA 1516Z	-	BK 1516	TLAM 1516	-	-
	21	16	HK 1516.2RS	TLA 1516UU	-	-	-	-	-
	21	22	HK 1522	TLA 1522Z	-	BK 1522	TLAM 1522	-	-
	22	10	-	-	TA 1510Z	-	-	TAM 1510	-
	22	12	-	-	TA 1512Z	-	-	TAM 1512	-
	22	15	-	-	TA 1515Z	-	-	TAM 1515	-
	22	20	-	-	TA 1520Z	-	-	TAM 1520	-
	22	25	-	-	TA 1525Z	-	-	TAM 1525	-

사양						적합한 Inner Ring	
동정격하중 C N	정정격하중 C ₀ N	허용 회전수 rpm ⁽¹⁾	동정격하중 C N	정정격하중 C ₀ N	허용 회전수 rpm ⁽¹⁾	Koyo	IKO
4,960	6,080	28,000	4,350	5,810	35,000	JR 8x12x10.5	IRT 810
-	-	-	7,470	11,800	13,000	-	IRT 810
6,610	7,290	22,000	6,420	7,490	35,000	JR 8x12x12.5	IRT 812
6,610	7,290	14,400	-	-	-	-	-
6,870	7,650	14,400	6,420	7,490	14,000	-	-
-	-	-	6,000	6,310	35,000	-	IRT 812
-	-	-	11,800	15,200	13,000	-	IRT 812
-	-	-	7,440	8,320	35,000	-	IRT 815
-	-	-	10,700	13,300	35,000	-	-
-	-	-	13,800	18,300	35,000	-	-
6,920	7,890	22,000	6,760	8,170	30,000	JR 10x13x12.5	IRT 1012
7,210	8,500	21,000	7,080	8,840	30,000	JR 10x14x12	IRT 1012-2
7,170	8,410	13,900	-	-	-	JR 10x14x16	-
-	-	-	8,950	12,000	30,000	-	IRT 1016-2
7,170	8,410	13,900	7,080	8,840	12,000	JR 10x14x20	IRT 1016-2
-	-	-	10,500	12,000	30,000	-	IRT 1016-2
-	-	-	13,900	17,200	30,000	-	IRT 1020-2
7,490	9,110	21,000	7,380	9,520	25,000	JR 12x15x12.5	IRT 1212
7,160	8,570	21,000	-	-	-	JR 12x15x12.5	-
7,870	9,690	13,000	-	-	-	JR 12x15x16.5	-
10,700	14,400	21,000	9,330	12,900	25,000	JR 12x15x16.5	IRT 1216
7,870	9,690	13,000	7,380	9,520	11,000	JR 12x15x16.5	IRT 1216
13,500	19,400	21,000	13,600	20,900	25,000	JR 12x15x22.5	IRT 1222
-	-	-	5,290	5,680	25,000	-	IRT 1010-1
-	-	-	7,120	8,310	25,000	-	IRT 1012-1
-	-	-	8,830	11,000	25,000	-	IRT 1015-1
-	-	-	12,700	17,600	25,000	-	IRT 1020-1
-	-	-	16,300	24,200	25,000	-	IRT 1025-1

(1) HK...RS, HK...2RS, TLA...UU는 그리스 주입시 허용회전수이며, 그 외에는 오일주입시 허용회전수입니다.

1.1 Shell Type Needle Roller Bearings

미리계열

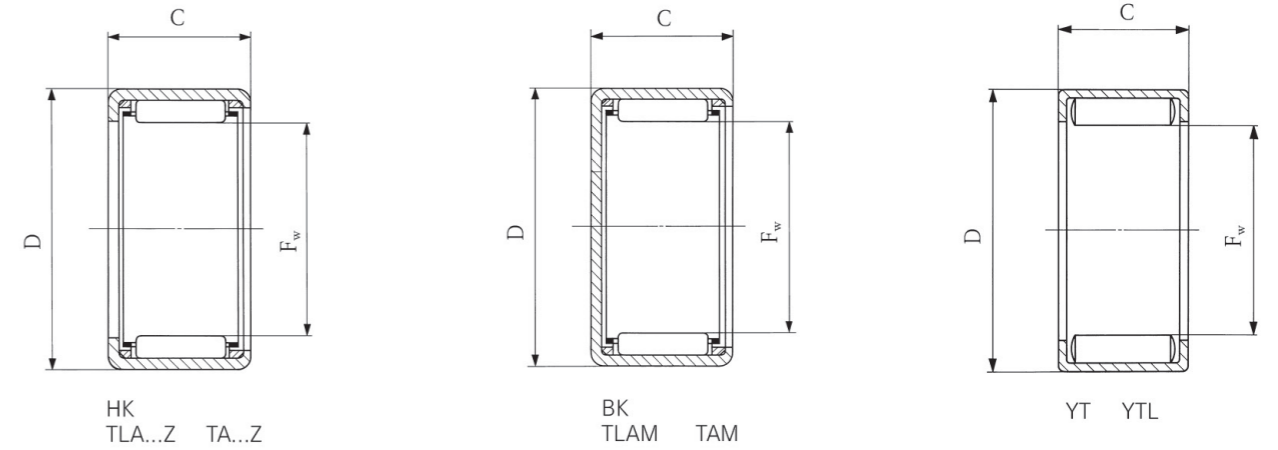

내경 F _w (mm)	외경 D (mm)	폭 C (mm)	유지기형						총롤러형
			Koyo	IKO	IKO	Koyo	IKO	IKO	IKO
			개방형1		개방형2	한쪽폐쇄형1		한쪽폐쇄형2	개방형
16	22	12	HK 1612	TLA 1612Z	-	BK 1612	TLAM 1612	-	-
	22	14	HK 1614RS	-	-	-	-	-	-
	22	16	HK 1616	TLA 1616Z	-	BK 1616	TLAM 1616	-	-
	22	16	HK 1616.2RS	TLA 1616UU	-	-	-	-	-
	22	22	HK 1622	TLA 1622Z	-	BK 1622	TLAM 1622	-	-
	24	16	-	-	TA 1616Z	-	-	TAM 1616	-
	24	20	-	-	TA 1620Z	-	-	TAM 1620	-
17	23	12	HK 1712	TLA 1712Z	-	BK 1712	TLAM 1712	-	-
	24	15	-	-	TA 1715Z	-	-	TAM 1715	-
	24	15	-	-	-	-	-	YT 1715	-
	24	20	-	-	TA 1720Z	-	-	TAM 1720	-
	24	25	-	-	TA 1725Z	-	-	TAM 1725	-
	24	25	-	-	-	-	-	YT 1725	-
18	24	12	HK 1812	TLA 1812Z	-	BK 1812	TLAM 1812	-	-
	24	14	HK 1814RS	-	-	-	-	-	-
	24	16	HK 1816	TLA 1816Z	-	BK 1816	TLAM 1816	-	-
	24	16	HK 1816.2RS	TLA 1816UU	-	-	-	-	-
	25	13	-	-	TA 1813Z	-	-	TAM 1813	-
	25	15	-	-	TA 1815Z	-	-	TAM 1815	-
	25	17	-	-	TA 1817Z	-	-	TAM 1817	-
	25	19	-	-	TA 1819Z	-	-	TAM 1819	-
	25	20	-	-	TA 1820Z	-	-	TAM 1820	-
	25	25	-	-	TA 1825Z	-	-	TAM 1825	-
19	27	16	-	-	TA 1916Z	-	-	TAM 1916	-
	27	20	-	-	TA 1920Z	-	-	TAM 1920	-

사양						적합한 Inner Ring	
동정격하중 C N	Koyo 정정격하중 C ₀ N	허용 회전수 rpm ⁽¹⁾	동정격하중 C N	IKO 정정격하중 C ₀ N	허용 회전수 rpm ⁽¹⁾	Koyo	IKO
7,760	9,720	21,000	7,670	10,200	25,000	JR 12x16x12	IRT 1212-1
7,820	9,760	12,100	-	-	-	JR 12x16x16	-
11,100	15,300	21,000	9,700	13,800	25,000	JR 12x16x16	IRT 1216-1
7,820	9,760	12,100	7,670	10,200	11,000	JR 12x16x20	IRT 1216-1
13,400	19,500	21,000	14,200	22,400	25,000	JR 12x16x22	IRT 1222-1
-	-	-	11,100	13,300	25,000	-	IRT 1216-1
-	-	-	14,700	19,100	25,000	-	IRT 1220-1
8,120	10,400	20,000	7,960	10,900	25,000	-	-
-	-	-	9,660	12,700	25,000	-	IRT 1215-2
-	-	-	16,600	26,000	9,000	-	IRT 1215-2
-	-	-	13,900	20,400	25,000	-	IRT 1220-2
-	-	-	17,900	28,100	25,000	-	IRT 1225-2
-	-	-	27,200	49,000	9,000	-	IRT 1225-2
8,410	11,110	18,000	8,230	11,500	20,000	-	IRT 1512
8,410	11,100	10,800	-	-	-	JR 15x18x16.5	-
11,600	16,800	18,000	10,400	15,600	20,000	JR 15x18x16.5	IRT 1516
8,410	11,100	10,800	8,230	11,500	9,000	JR 15x18x16.5	IRT 1516
-	-	-	9,100	12,000	20,000	-	IRT 1513
-	-	-	10,100	13,600	20,000	-	IRT 1515
-	-	-	11,900	16,900	20,000	-	IRT 1517
-	-	-	13,700	20,200	20,000	-	IRT 1519
-	-	-	14,500	21,800	20,000	-	IRT 1520
-	-	-	18,600	30,000	20,000	-	IRT 1525
-	-	-	12,200	15,700	20,000	-	IRT 1516-1
-	-	-	16,100	22,600	20,000	-	IRT 1520-1

(1) HK...RS, HK...2RS, TLA...UU는 그리스 주입시 허용회전수이며, 그 외에는 오일주입시 허용회전수입니다.

1.1 Shell Type Needle Roller Bearings

미리계열

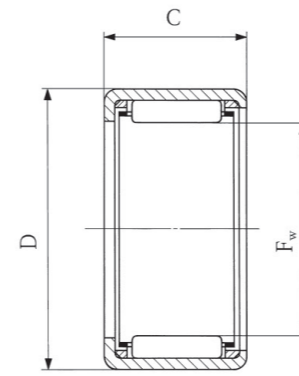

HK
TLA...Z TA...Z

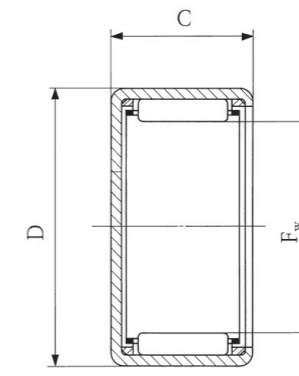

BK
TLAM TAM

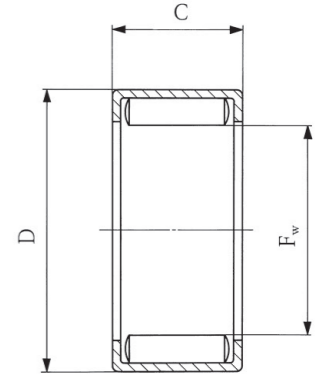

YT YTL

내경 F _w (mm)	외경 D (mm)	폭 C (mm)	유지기형						총롤러형	
			Koyo	IKO	IKO	Koyo	IKO	IKO	IKO	
			개방형1		개방형2	한쪽폐쇄형1		한쪽폐쇄형2	개방형	
20	26	12	HK 2012	TLA 2012Z	-	BK 2012	TLAM 2012	-	-	
	26	16	HK 2016	TLA 2016Z	-	BK 2016	TLAM 2016	-	-	
	26	16	HK 2016.2RS	TLA 2016UU	-	-	-	-	-	
	26	18	HK 2018RS	-	-	-	-	-	-	
	26	20	HK 2020	TLA 2020Z	-	-	TLAM 2020	-	-	
	26	20	-	-	-	BK 2020	-	-	-	
	26	20	HK 2020.2RS	TLA 2020UU	-	-	-	-	-	
	26	30	HK 2030	TLA 2030Z	-	BK 2030	TLAM 2030	-	-	
	27	15	-	-	TA 2015Z	-	-	TAM 2015	-	
	27	15	-	-	-	-	-	-	YT 2015	
	27	20	-	-	TA 2020Z	-	-	TAM 2020	-	
	27	25	-	-	TA 2025Z	-	-	TAM 2025	-	
	27	25	-	-	-	-	-	-	YT 2025	
	27	30	-	-	TA 2030Z	-	-	TAM 2030	-	
	28	20	-	-	TA 202820Z	-	-	TAM 202820	-	
	28	20	-	-	-	-	-	-	YT 202820	
	21	29	16	-	-	TA 2116Z	-	-	TAM 2116	-
		29	16	-	-	-	-	-	-	YT 2116
29		20	-	-	TA 2120Z	-	-	TAM 2120	-	
29		20	-	-	-	-	-	-	YT 2120	

사양						적합한 Inner Ring	
동정격하중 C N	Koyo 정정격하중 C ₀ N	허용 회전수 rpm ⁽¹⁾	동정격하중 C N	IKO 정정격하중 C ₀ N	허용 회전수 rpm ⁽¹⁾	Koyo	IKO
8,970	12,500	16,000	8,740	12,900	20,000	JR 15x20x12	-
12,400	18,900	16,000	11,100	17,500	20,000	JR 17x20x16.5	IRT 1716
8,970	12,500	9,700	8,740	12,900	9,000	JR 17x20x16.5	IRT 1716
12,400	18,900	9,700	-	-	-	JR 17x20x20.5	-
15,900	26,200	16,000	14,500	24,700	20,000	JR 17x20x20.5	IRT 1720
15,500	25,300	16,000	-	-	-	JR 17x20x20.5	-
12,400	18,900	9,700	11,100	17,500	9,000	JR 17x20x20.5	IRT 1720
21,200	37,800	16,000	22,300	42,900	20,000	JR 17x20x30.5	IRT 1730
-	-	-	10,400	14,600	20,000	-	IRT 1515-2
-	-	-	18,400	30,900	7,500	-	IRT 1515-2
-	-	-	15,000	23,400	20,000	-	IRT 1520-2
-	-	-	19,200	32,200	20,000	-	IRT 1525-2
-	-	-	30,000	58,300	7,500	-	IRT 1525-2
-	-	-	23,100	41,000	20,000	-	IRT 1530-2
-	-	-	16,900	24,300	20,000	-	IRT 1520-2
-	-	-	26,800	44,600	7,500	-	IRT 1520-2
-	-	-	13,300	18,100	19,000	-	IRT 1716-1
-	-	-	22,100	35,200	7,000	-	IRT 1716-1
-	-	-	17,600	25,900	19,000	-	IRT 1720-1
-	-	-	27,500	46,800	7,000	-	IRT 1720-1

(1) HK..RS, HK..2RS, TLA..UU는 그리스 주입시 허용회전수이며, 그 외에는 오일주입시 허용회전수 입니다.

1.1 Shell Type Needle Roller Bearings

미리계열

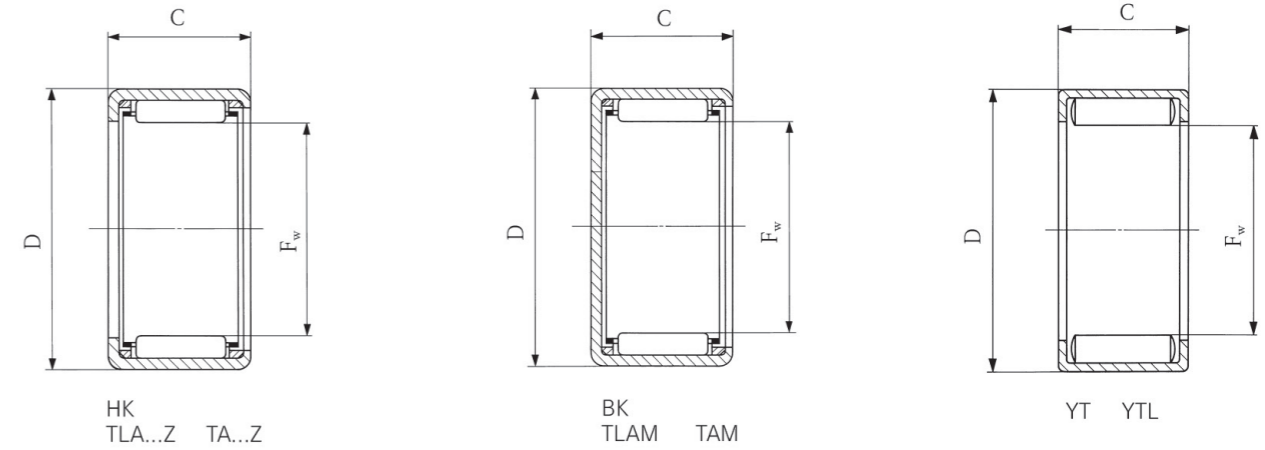

내경 F _w (mm)	외경 D (mm)	폭 C (mm)	유지기형						총롤러형
			Koyo	IKO	IKO	Koyo	IKO	IKO	IKO
			개방형1		개방형2	한쪽폐쇄형1		한쪽폐쇄형2	개방형
22	28	12	HK 2212	TLA 2212Z	-	BK 2212	TLAM 2212	-	-
	28	16	HK 2216	TLA 2216Z	-	BK 2216	TLAM 2216	-	-
	28	16	HK 2216.2RS	TLA 2216UU	-	-	-	-	-
	28	18	HK 2218RS	-	-	-	-	-	-
	28	20	HK 2220	TLA 2220Z	-	BK 2220	TLAM 2220	-	-
	28	20	HK 2220.2RS	TLA 2220UU	-	-	-	-	-
	29	10	-	-	TA 2210Z	-	-	TAM 2210	-
	29	15	-	-	TA 2215Z	-	-	TAM 2215	-
	29	20	-	-	TA 2220Z	-	-	TAM 2220	-
	29	25	-	-	TA 2225Z	-	-	TAM 2225	-
	29	30	-	-	TA 2230Z	-	-	TAM 2230	-
	30	16	-	-	TA 223016Z	-	-	TAM 223016	-
	30	16	-	-	-	-	-	-	YT 223016
	30	20	-	-	TA 223020Z	-	-	TAM 223020	-
	30	20	-	-	-	-	-	-	YT 223020
	24	31	20	-	-	TA 2420Z	-	-	TAM 2420
31		28	-	-	TA 2428Z	-	-	TAM 2428	-
31		28	-	-	-	-	-	-	YT 2428
32		16	-	-	TA 243216Z	-	-	TAM 243216	-
32		16	-	-	-	-	-	-	YT 243216
32		20	-	-	TA 243220Z	-	-	TAM 243220	-
32		20	-	-	-	-	-	-	YT 243220

사양						적합한 Inner Ring	
동정격하중 C N	정정격하중 C ₀ N	허용 회전수 rpm ⁽¹⁾	동정격하중 C N	정정격하중 C ₀ N	허용 회전수 rpm ⁽¹⁾	Koyo	IKO
9,810	14,500	15,000	9,230	14,300	18,000	JR 17x22x13	-
13,100	20,900	15,000	11,700	19,300	18,000	JR 17x22x16	IRT 1716-2
9,810	14,500	8,800	9,230	14,300	8,000	JR 17x22x16	IRT 1716-2
13,100	20,900	8,800	-	-	-	JR 17x22x23	-
15,300	25,500	15,000	15,300	27,300	18,000	JR 17x22x23	IRT 1720-2
13,100	20,900	8,800	11,700	19,300	8,000	JR 17x22x23	IRT 1720-2
-	-	-	6,650	8,500	18,000	-	IRT 1710-2
-	-	-	11,100	16,400	18,000	-	IRT 1715-2
-	-	-	16,000	26,300	18,000	-	IRT 1720-2
-	-	-	19,700	34,300	18,000	-	IRT 1725-2
-	-	-	23,800	43,700	18,000	-	IRT 1730-2
-	-	-	13,200	18,200	18,000	-	IRT 1716-2
-	-	-	22,600	36,800	7,000	-	IRT 1716-2
-	-	-	17,500	26,100	18,000	-	IRT 1720-2
-	-	-	28,200	48,900	7,000	-	IRT 1720-2
-	-	-	17,000	29,200	16,000	-	IRT 2020
-	-	-	24,500	46,700	16,000	-	IRT 2028
-	-	-	36,800	79,900	6,500	-	IRT 2028
-	-	-	14,200	20,500	16,000	-	IRT 2016
-	-	-	23,700	40,100	6,500	-	IRT 2016
-	-	-	18,800	29,400	16,000	-	IRT 2020
-	-	-	29,500	53,200	6,500	-	IRT 2020

(1) HK..RS, HK..2RS, TLA..UU는 그리스 주입시 허용회전수이며, 그 외에는 오일주입시 허용회전수 입니다.

1.1 Shell Type Needle Roller Bearings

미리계열

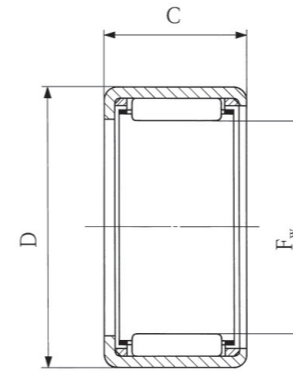

HK
TLA...Z TA...Z

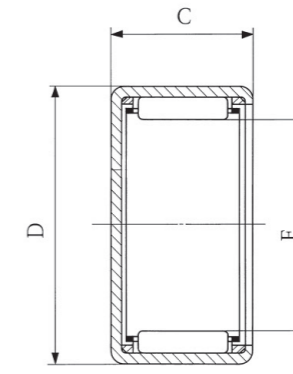

BK
TLAM TAM

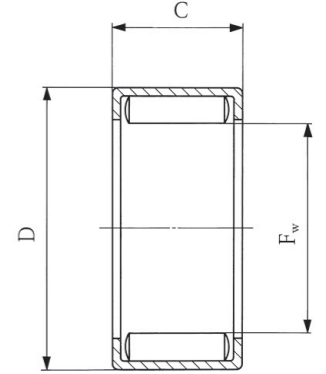

YT YTL

내경 F _w (mm)	외경 D (mm)	폭 C (mm)	유지기형						총롤러형
			Koyo	IKO	IKO	Koyo	IKO	IKO	IKO
			개방형1		개방형2	한쪽폐쇄형1		한쪽폐쇄형2	개방형
25	32	12	HK 2512	TLA 2512Z	-	BK 2512	TLAM 2512	-	-
	32	14	HK 2514RS	-	-	-	-	-	-
	32	16	HK 2516	TLA 2516Z	-	BK 2516	TLAM 2516	-	-
	32	16	HK 2516.2RS	TLA 2516UU	-	-	-	-	-
	32	18	HK 2518RS	-	-	-	-	-	-
	32	20	HK 2520	TLA 2520Z	-	BK 2520	TLAM 2520	-	-
	32	20	HK 2520.2RS	TLA 2520UU	-	-	-	-	-
	32	22	HK 2522RS	-	-	-	-	-	-
	32	24	HK 2524.2RS	-	-	-	-	-	-
	32	26	HK 2526	TLA 2526Z	-	BK 2526	TLAM 2526	-	-
	32	26	-	-	-	-	-	-	YTL 2526
	32	38	HK 2538	TLAW 2538Z	-	BK 2538	TLAMW 2538	-	-
	33	10	-	-	TA 2510Z	-	-	TAM 2510	-
	33	10	-	-	-	-	-	-	YT 2510
	33	15	-	-	TA 2515Z	-	-	TAM 2515	-
	33	15	-	-	-	-	-	-	YT 2515
	33	20	-	-	TA 2520Z	-	-	TAM 2520	-
	33	20	-	-	-	-	-	-	YT 2520
	33	25	-	-	TA 2525Z	-	-	TAM 2525	-
	33	25	-	-	-	-	-	-	YT 2525
33	30	-	-	TA 2530Z	-	-	TAM 2530	-	
26	34	16	-	-	TA 2616Z	-	-	TAM 2616	-
	34	16	-	-	-	-	-	-	YT 2616
	34	20	-	-	TA 2620Z	-	-	TAM 2620	-
	34	20	-	-	-	-	-	-	YT 2620

사양						적합한 Inner Ring	
동정격하중 C N	정정격하중 C ₀ N	허용 회전수 rpm ⁽¹⁾	동정격하중 C N	정정격하중 C ₀ N	허용 회전수 rpm ⁽¹⁾	Koyo	IKO
10,900	14,700	13,000	9,440	13,900	15,000	-	-
10,900	14,700	7,800	-	-	-	JR 20x25x17	-
15,600	23,500	13,000	12,800	20,500	15,000	JR 20x25x17	-
11,100	15,100	7,800	9,440	13,900	7,000	JR 20x25x17	-
16,200	24,600	7,800	-	-	-	JR 20x25x20.5	-
20,600	33,400	13,000	16,900	29,300	15,000	JR 20x25x20.5	IRT 2020-1
16,200	24,600	7,800	12,800	20,500	7,000	JR 20x25x20.5	IRT 2020-1
20,600	33,400	7,800	-	-	-	JR 20x25x26	-
20,600	33,400	7,800	-	-	-	JR 20x25x26	-
25,700	44,400	13,000	22,600	42,500	15,000	JR 20x25x26.5	IRT 2026-1
-	-	-	35,000	75,800	6,000	-	IRT 2026-1
35,300	66,900	13,000	28,900	58,500	15,000	JR 20x25x38.5	IRT 2038-1
-	-	-	7,990	9,900	15,000	-	IRT 2010-1
-	-	-	15,500	23,600	6,000	-	IRT 2010-1
-	-	-	13,400	19,300	15,000	-	IRT 2015-1
-	-	-	22,700	38,300	6,000	-	IRT 2015-1
-	-	-	19,500	31,100	15,000	-	IRT 2020-1
-	-	-	30,200	55,400	6,000	-	IRT 2020-1
-	-	-	24,100	40,800	15,000	-	IRT 2025-1
-	-	-	37,200	72,500	6,000	-	IRT 2025-1
-	-	-	29,100	52,000	15,000	-	IRT 2030-1
-	-	-	15,200	22,900	15,000	-	IRT 2216
-	-	-	24,700	43,300	6,000	-	IRT 2216
-	-	-	20,100	32,800	15,000	-	IRT 2220
-	-	-	30,800	57,500	6,000	-	IRT 2220

(1) HK..RS, HK..2RS, TLA..UU는 그리스 주입시 허용회전수이며, 그 외에는 오일주입시 허용회전수 입니다.

1.1 Shell Type Needle Roller Bearings

미리계열

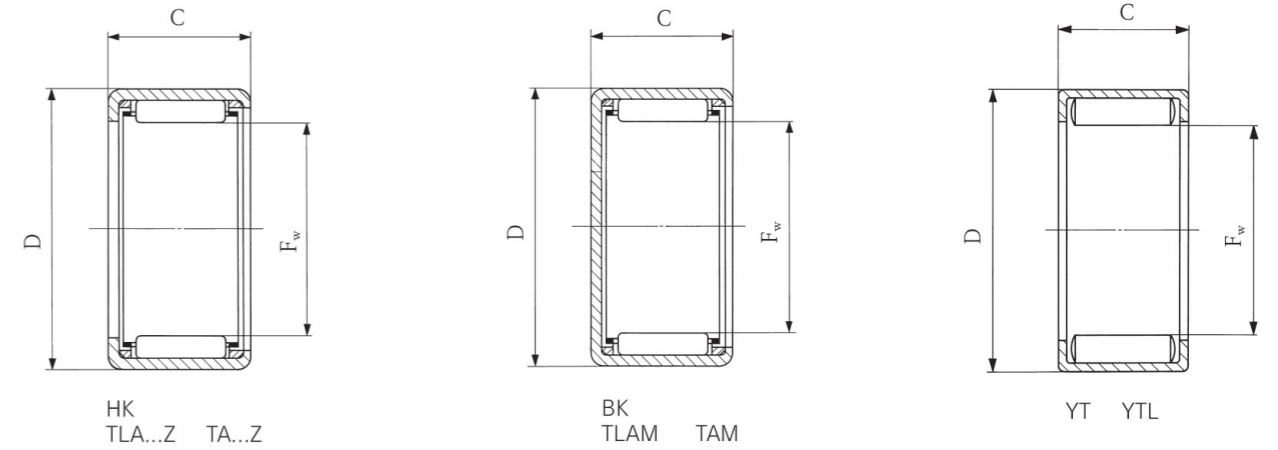

내경 F _w (mm)	외경 D (mm)	폭 C (mm)	유지기형						총롤러형
			Koyo	IKO	IKO	Koyo	IKO	IKO	IKO
			개방형1		개방형2	한쪽폐쇄형1		한쪽폐쇄형2	개방형
28	35	16	HK 2816	TLA 2816Z	-	BK 2816	TLAM 2816	-	-
	35	20	HK 2820	TLA 2820Z	-	BK 2820	TLAM 2820	-	-
	35	20	HK 2820.2RS	TLA 2820UU	-	-	-	-	-
	37	20	-	-	TA 2820Z	-	-	TAM 2820	-
	37	20	-	-	-	-	-	-	YT 2820
	37	30	-	-	TA 2830Z	-	-	TAM 2830	-
29	38	20	-	-	TA 2920Z	-	-	TAM 2920	-
	38	20	-	-	-	-	-	-	YT 2920
	38	30	-	-	TA 2930Z	-	-	TAM 2930	-
30	37	12	HK 3012	TLA 3012Z	-	-	TLAM 3012	-	-
	37	12	-	-	-	BK 3012	-	-	-
	37	16	HK 3016	TLA 3016Z	-	BK 3016	TLAM 3016	-	-
	37	16	HK 3016.2RS	TLA 3016UU	-	-	-	-	-
	37	18	HK 3018RS	TLA 3018Z	-	-	TLAM 3018	-	-
	37	20	HK 3020	TLA 3020Z	-	BK 3020	TLAM 3020	-	-
	37	20	HK 3020.2RS	TLA 3020UU	-	-	-	-	-
	37	22	HK 3022RS	-	-	-	-	-	-
	37	24	HK 3024.2RS	-	-	-	-	-	-
	37	26	HK 3026	TLA 3026Z	-	BK 3026	TLAM 3026	-	-
	37	38	HK 3038	TLAW 3038Z	-	BK 3038	TLAMW 3038	-	-
	40	13	-	-	TA 3013Z	-	-	TAM 3013	-
	40	15	-	-	TA 3015Z	-	-	TAM 3015	-
	40	20	-	-	TA 3020Z	-	-	TAM 3020	-
40	25	-	-	TA 3025Z	-	-	TAM 3025	-	
40	30	-	-	TA 3030Z	-	-	TAM 3030	-	
32	42	20	-	-	TA 3220Z	-	-	TAM 3220	-
	42	20	-	-	-	-	-	-	YT 3220
	42	30	-	-	TA 3230Z	-	-	TAM 3230	-

사양						적합한 Inner Ring	
동정격하중 C N	Koyo 정정격하중 C ₀ N	허용 회전수 rpm ⁽¹⁾	동정격하중 C N	IKO 정정격하중 C ₀ N	허용 회전수 rpm ⁽¹⁾	Koyo	IKO
15,900	24,900	12,000	13,800	23,500	13,000	JR 22x28x17	-
20,900	35,300	12,000	18,300	33,600	13,000	JR 22x28x20.5	IRT 2220-1
15,900	24,900	6,900	13,800	23,500	6,000	JR 22x28x20.5	IRT 2220-1
-	-	-	21,200	32,300	13,000	-	IRT 2220-1
-	-	-	34,700	61,700	5,500	-	IRT 2220-1
-	-	-	33,000	56,900	13,000	-	IRT 2230-1
-	-	-	22,000	34,200	13,000	-	IRT 2520
-	-	-	35,500	64,100	5,000	-	IRT 2520
-	-	-	34,200	60,300	13,000	-	IRT 2530
12,000	17,700	11,000	10,400	16,600	12,000	-	-
11,600	16,800	11,000	-	-	-	-	-
16,800	27,300	11,000	14,100	24,500	12,000	JR 25x30x17	-
11,600	16,800	6,500	10,400	16,600	5,500	JR 25x30x17	-
16,800	27,300	6,500	16,400	29,800	12,000	JR 25x30x20.5	-
22,400	39,600	11,000	18,600	35,100	12,000	JR 25x30x20.5	IRT 2520-1
16,800	27,300	6,500	14,100	24,500	5,500	JR 25x30x20.5	IRT 2520-1
22,400	39,600	6,500	-	-	-	JR 25x30x26	-
22,400	39,600	6,500	-	-	-	JR 25x30x26	-
27,400	51,200	11,000	24,800	50,900	12,000	JR 25x30x26.5	IRT 2526-1
38,400	79,200	11,000	31,900	70,200	12,000	JR 25x30x38.5	IRT 2538-1
-	-	-	13,500	16,800	12,000	-	-
-	-	-	16,800	22,400	12,000	-	IRT 2515-1
-	-	-	24,500	36,300	12,000	-	IRT 2520-1
-	-	-	31,600	50,300	12,000	-	IRT 2525-1
-	-	-	36,700	60,700	12,000	-	IRT 2530-1
-	-	-	25,400	38,600	11,000	-	IRT 2820
-	-	-	39,900	70,100	4,500	-	IRT 2820
-	-	-	39,500	68,400	11,000	-	IRT 2830

(1) HK..RS, HK..2RS, TLA..UU는 그리스 주입시 허용회전수이며, 그 외에는 오일주입시 허용회전수입니다.

1.1 Shell Type Needle Roller Bearings

미리계열

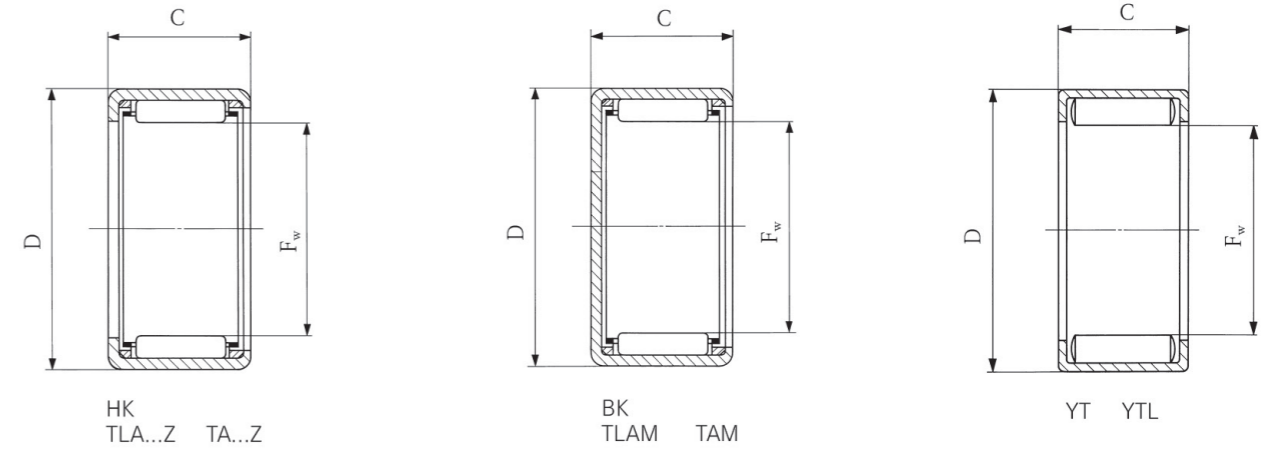

내경 F _w (mm)	외경 D (mm)	폭 C (mm)	유지기형						총롤러형
			Koyo	IKO	IKO	Koyo	IKO	IKO	IKO
			개방형1		개방형2	한쪽폐쇄형1		한쪽폐쇄형2	개방형
35	42	12	HK 3512	TLA 3512Z	-	-	TLAM 3512	-	-
	42	16	HK 3516	TLA 3516Z	-	-	TLAM 3516	-	-
	42	16	HK 3516.2RS	TLA 3516UU	-	-	-	-	-
	42	18	HK 3518RS	-	-	-	-	-	-
	42	20	HK 3520	TLA 3520Z	-	BK 3520	TLAM 3520	-	-
	42	20	HK 3520.2RS	TLA 3520UU	-	-	-	-	-
	45	12	-	-	TA 3512Z	-	-	TAM 3512	-
	45	15	-	-	TA 3515Z	-	-	TAM 3515	-
	45	20	-	-	TA 3520Z	-	-	TAM 3520	-
	45	25	-	-	TA 3525Z	-	-	TAM 3525	-
37	47	20	-	-	TA 3720Z	-	-	TAM 3720	-
	47	20	-	-	-	-	-	YT 3720	-
	47	30	-	-	TA 3730Z	-	-	TAM 3730	-
38	48	15	-	-	TA 3815Z	-	-	TAM 3815	-
	48	20	-	-	TA 3820Z	-	-	TAM 3820	-
	48	25	-	-	TA 3825Z	-	-	TAM 3825	-
	48	30	-	-	TA 3830Z	-	-	TAM 3830	-
	48	45	-	-	TAW 3845Z	-	-	TAMW 3845	-

사양						적합한 Inner Ring	
동정격하중 C N	정정격하중 C ₀ N	허용 회전수 rpm ⁽¹⁾	동정격하중 C N	정정격하중 C ₀ N	허용 회전수 rpm ⁽¹⁾	Koyo	IKO
13,000	20,600	9,100	11,600	20,000	10,000	-	IRT 3012
17,400	29,900	9,100	15,700	29,600	10,000	JR 30x35x17	-
14,200	23,200	5,500	11,600	20,000	5,000	JR 30x35x17	-
17,400	29,900	5,500	-	-	-	JR 30x35x20.5	-
24,500	46,800	9,100	20,700	42,300	10,000	JR 30x35x20.5	IRT 3020
17,400	29,900	5,500	15,700	29,600	5,000	JR 30x35x20.5	IRT 3020
-	-	-	14,800	19,900	10,000	-	IRT 3012
-	-	-	18,500	26,500	10,000	-	IRT 3015
-	-	-	27,000	43,100	10,000	-	IRT 3020
-	-	-	34,800	59,700	10,000	-	IRT 3025
-	-	-	40,600	72,600	10,000	-	IRT 3030
-	-	-	27,800	45,400	9,500	-	IRT 3220
-	-	-	43,300	81,300	4,000	-	IRT 3220
-	-	-	41,800	76,700	9,500	-	IRT 3230
-	-	-	19,000	28,000	9,000	-	IRT 3215-1
-	-	-	27,700	45,600	9,000	-	IRT 3220-1
-	-	-	35,600	63,100	9,000	-	IRT 3225-1
-	-	-	43,100	80,600	9,000	-	IRT 3230-1
-	-	-	55,700	112,000	9,000	-	IRT 3245-1

(1) HK..RS, HK..2RS, TLA..UU는 그리스 주입시 허용회전수이며, 그 외에는 오일주입시 허용회전수 입니다.

1.1 Shell Type Needle Roller Bearings

미리계열

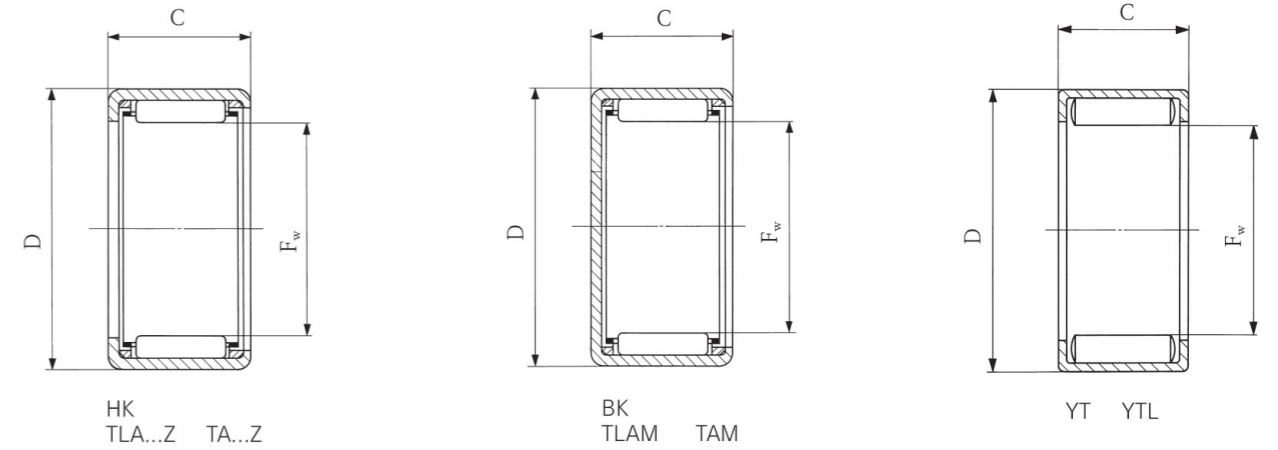

내경 F _w (mm)	외경 D (mm)	폭 C (mm)	유지기형						총롤러형
			Koyo	IKO	IKO	Koyo	IKO	IKO	IKO
			개방형1		개방형2	한쪽폐쇄형1		한쪽폐쇄형2	개방형
40	47	12	HK 4012	TLA 4012Z	-	-	TLAM 4012	-	-
	47	16	HK 4016	TLA 4016Z	-	-	TLAM 4016	-	-
	47	16	HK 4016.2RS	TLA 4016UU	-	-	-	-	-
	47	18	HK 4018RS	-	-	-	-	-	-
	47	20	HK 4020	TLA 4020Z	-	BK 4020	TLAM 4020	-	-
	47	20	HK 4020.2RS	TLA 4020UU	-	-	-	-	-
	50	15	-	-	TA 4015Z	-	-	TAM 4015	-
	50	15	-	-	-	-	-	-	YT 4015
	50	20	-	-	TA 4020Z	-	-	TAM 4020	-
	50	25	-	-	TA 4025Z	-	-	TAM 4025	-
	50	25	-	-	-	-	-	-	YT 4025
	50	30	-	-	TA 4030Z	-	-	TAM 4030	-
	50	40	-	-	TA 4040Z	-	-	TAM 4040	-
45	52	16	HK 4516	TLA 4516Z	-	-	TLAM 4516	-	-
	52	18	HK 4518RS	-	-	-	-	-	-
	52	20	HK 4520	TLA 4520Z	-	-	TLAM 4520	-	-
	52	20	-	-	-	BK 4520	-	-	-
	52	20	HK 4520.2RS	TLA 4520UU	-	-	-	-	-
	55	20	-	-	TA 4520Z	-	-	TAM 4520	-
	55	20	-	-	-	-	-	-	YT 4520
	55	25	-	-	TA 4525Z	-	-	TAM 4525	-
	55	25	-	-	-	-	-	-	YT 4525
	55	30	-	-	TA 4530Z	-	-	TAM 4530	-
55	40	-	-	TA 4540Z	-	-	TAM 4540	-	

사양						적합한 Inner Ring	
동정격하중 C N	정정격하중 C ₀ N	허용 회전수 rpm ⁽¹⁾	동정격하중 C N	정정격하중 C ₀ N	허용 회전수 rpm ⁽¹⁾	Koyo	IKO
14,700	25,300	7,900	12,400	22,800	8,500	-	-
18,900	34,800	7,900	16,700	33,700	8,500	JR 35x40x17	-
13,400	22,400	4,900	12,400	22,800	4,500	JR 35x40x20	-
18,900	34,800	4,900	-	-	-	JR 35x40x20.5	-
25,100	50,400	7,900	22,100	48,200	8,500	JR 35x40x20.5	IRT 3520
18,900	34,800	4,900	16,700	33,700	4,500	JR 35x40x20.5	IRT 3520
-	-	-	19,500	29,400	8,500	-	IRT 3515
-	-	-	33,400	59,800	4,000	-	IRT 3515
-	-	-	28,400	47,800	8,500	-	IRT 3520
-	-	-	36,600	66,200	8,500	-	IRT 3525
-	-	-	55,300	114,000	4,000	-	IRT 3525
-	-	-	44,300	84,600	8,500	-	IRT 3530
-	-	-	56,700	116,000	8,500	-	IRT 3540
19,800	38,500	7,000	17,800	37,800	7,500	JR 40x45x17	-
19,800	38,500	4,300	-	-	-	JR 40x45x20.5	-
27,200	58,200	7,000	23,400	54,000	7,500	JR 40x45x20.5	IRT 4020
26,300	55,400	7,000	-	-	-	JR 40x45x20.5	-
19,800	38,500	4,300	17,800	37,800	4,000	JR 40x45x20.5	IRT 4020
-	-	-	30,600	54,600	7,500	-	IRT 4020
-	-	-	47,800	98,200	3,500	-	IRT 4020
-	-	-	39,400	75,600	7,500	-	IRT 4025
-	-	-	59,100	129,000	3,500	-	IRT 4025
-	-	-	47,700	96,600	7,500	-	IRT 4030
-	-	-	61,300	133,000	7,500	-	IRT 4040

(1) HK..RS, HK..2RS, TLA..UU는 그리스 주입시 허용회전수이며, 그 외에는 오일주입시 허용회전수입니다.

1.1 Shell Type Needle Roller Bearings

미리계열

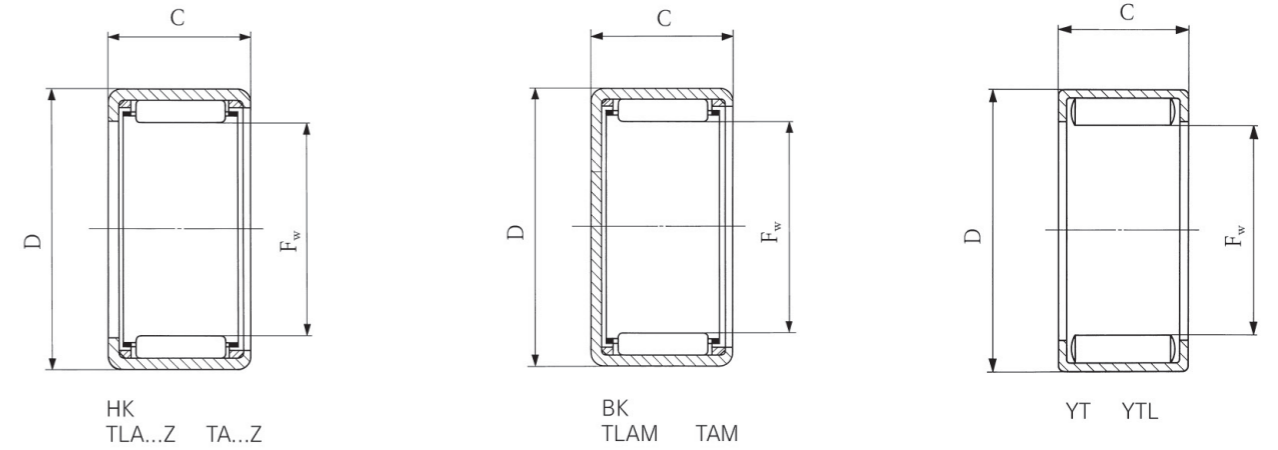

내경 F _w (mm)	외경 D (mm)	폭 C (mm)	유지기형						총롤러형
			Koyo	IKO	IKO	Koyo	IKO	IKO	IKO
			개방형1		개방형2	한쪽폐쇄형1		한쪽폐쇄형2	개방형
50	58	20	HK 5020	TLA 5020Z	-	-	TLAM 5020	-	-
	58	22	HK 5022RS	-	-	-	-	-	-
	58	24	HK 5024.2RS	-	-	-	-	-	-
	58	25	HK 5025	TLA 5025Z	-	-	TLAM 5025	-	-
	58	26	-	TLA 5026UU	-	-	-	-	-
	62	12	-	-	TA 5012Z	-	-	TAM 5012	-
	62	15	-	-	TA 5015Z	-	-	TAM 5015	-
	62	20	-	-	TA 5020Z	-	-	TAM 5020	-
	62	25	-	-	TA 5025Z	-	-	TAM 5025	-
	62	30	-	-	TA 5030Z	-	-	TAM 5030	-
	62	40	-	-	TA 5040Z	-	-	TAM 5040	-
	62	45	-	-	TAW 5045Z	-	-	TAMW 5045	-
55	63	20	-	TLA 5520Z	-	-	TLAM 5520	-	-
	63	25	-	TLA 5525Z	-	-	TLAM 5525	-	-
	67	20	-	-	TA 5520Z	-	-	TAM 5520	-
	67	25	-	-	TA 5525Z	-	-	TAM 5525	-
	67	30	-	-	TA 5530Z	-	-	TAM 5530	-
	67	40	-	-	TA 5540Z	-	-	TAM 5540	-
	67	45	-	-	TAW 5545Z	-	-	TAMW 5545	-
	67	50	-	-	TAW 5550Z	-	-	TAMW 5550	-

사양						적합한 Inner Ring	
동정격하중 C N	정정격하중 C ₀ N	허용 회전수 rpm ⁽¹⁾	동정격하중 C N	정정격하중 C ₀ N	허용 회전수 rpm ⁽¹⁾	Koyo	IKO
30,900	62,200	6,300	28,800	64,100	6,500	JR 45x50x20	IRT 4520
28,800	56,600	3,900	-	-	-	JR 45x50x25.5	-
28,800	56,600	3,900	-	-	-	JR 45x50x25.5	-
35,500	74,100	6,300	36,900	88,400	6,500	JR 45x50x25.5	IRT 4525
-	-	-	28,800	64,100	3,500	-	-
-	-	-	17,700	24,000	6,500	-	IRT 4512
-	-	-	25,800	39,000	6,500	-	IRT 4515
-	-	-	38,000	64,000	6,500	-	IRT 4520
-	-	-	49,100	89,000	6,500	-	IRT 4525
-	-	-	59,500	114,000	6,500	-	IRT 4530
-	-	-	76,500	157,000	6,500	-	IRT 4540
-	-	-	76,700	158,000	6,500	-	IRT 4545
-	-	-	29,800	69,400	5,500	-	IRT 5020-1
-	-	-	38,300	95,700	5,500	-	IRT 5025-1
-	-	-	39,600	69,700	5,500	-	IRT 5020-1
-	-	-	51,200	97,000	5,500	-	IRT 5025-1
-	-	-	62,000	124,000	5,500	-	IRT 5030-1
-	-	-	80,000	172,000	5,500	-	IRT 5040-1
-	-	-	79,900	172,000	5,500	-	IRT 5045-1
-	-	-	91,500	205,000	5,500	-	IRT 5050-1

(1) HK...RS, HK...2RS, TLA...UU는 그리스 주입시 허용회전수이며, 그 외에는 오일주입시 허용회전수 입니다.

1.1 Shell Type Needle Roller Bearings

미리계열

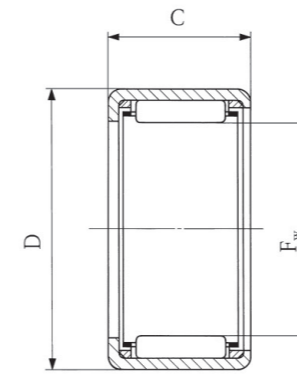

HK
TLA...Z TA...Z

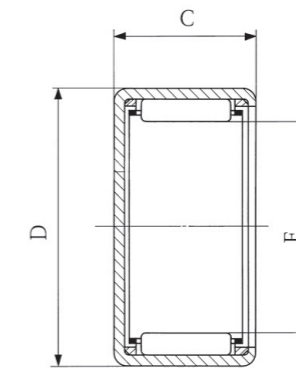

BK
TLAM TAM

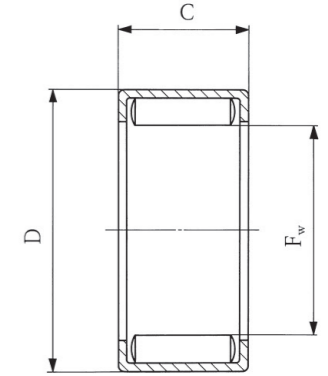

YT YTL

내경 Fw (mm)	외경 D (mm)	폭 C (mm)	유지기형						총롤러형
			Koyo		IKO		IKO		IKO
			개방형1		개방형2		한쪽폐쇄형1		한쪽폐쇄형2
60	68	12	HK 6012	-	-	-	-	-	-
	72	25	-	-	TA 6025Z	-	-	TAM 6025	-
	72	30	-	-	TA 6030Z	-	-	TAM 6030	-
	72	40	-	-	TA 6040Z	-	-	TAM 6040	-
	72	45	-	-	TAW 6045Z	-	-	TAMW 6045	-
	72	50	-	-	TAW 6050Z	-	-	TAMW 6050	-
62	74	12	-	-	TA 6212Z	-	-	TAM 6212	-
65	77	25	-	-	TA 6525Z	-	-	TAM 6525	-
	77	30	-	-	TA 6530Z	-	-	TAM 6530	-
	77	45	-	-	TAW 6545Z	-	-	TAMW 6545	-
	77	50	-	-	TAW 6550Z	-	-	TAMW 6550	-
70	82	25	-	-	TA 7025Z	-	-	TAM 7025	-
	82	30	-	-	TA 7030Z	-	-	TAM 7030	-
	82	40	-	-	TA 7040Z	-	-	TAM 7040	-
	82	50	-	-	TAW 7050Z	-	-	TAMW 7050	-

사양						적합한 Inner Ring	
동정격하중 C N	정정격하중 C ₀ N	허용 회전수 rpm ⁽¹⁾	동정격하중 C N	정정격하중 C ₀ N	허용 회전수 rpm ⁽¹⁾	Koyo	IKO
17,200	31,200	5,200	-	-	-	-	-
-	-	-	54,700	108,000	5,000	-	IRT 5025
-	-	-	66,300	139,000	5,000	-	IRT 5030
-	-	-	85,700	193,000	5,000	-	IRT 5040
-	-	-	85,400	193,000	5,000	-	IRT 5045
-	-	-	97,800	229,000	5,000	-	IRT 5050
-	-	-	20,100	30,300	4,500	-	IRT 5212
-	-	-	56,500	116,000	4,000	-	IRT 5525
-	-	-	68,500	149,000	4,000	-	IRT 5530
-	-	-	88,300	207,000	4,000	-	IRT 5545
-	-	-	101,000	246,000	4,000	-	IRT 5550
-	-	-	58,500	124,000	3,500	-	IRT 6025
-	-	-	70,900	159,000	3,500	-	IRT 6030
-	-	-	92,000	222,000	3,500	-	IRT 6040
-	-	-	105,000	262,000	3,500	-	IRT 6050

(1) HK..RS, HK..2RS, TLA..UU는 그리스 주입시 허용회전수이며, 그 외에는 오일주입시 허용회전수입니다.

1.1 Shell Type Needle Roller Bearings

인치계열

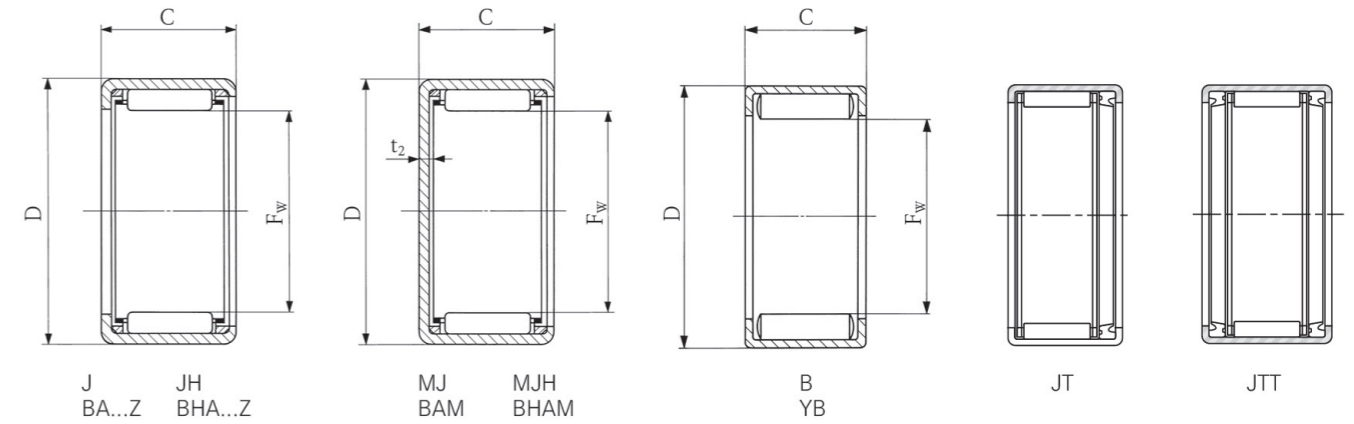

내경 F _w (mm)	외경 D (mm)	폭 C (mm)	유지기형							
			Koyo		IKO		Koyo		IKO	
			개방형1		개방형2		한쪽폐쇄형1		한쪽폐쇄형2	
3.175 ($\frac{1}{8}$)	6.350($\frac{1}{4}$)	4.78(.188)	JP-23-F	-	-	-	-	-	-	-
	6.350($\frac{1}{4}$)	6.35(.250)	-	-	-	-	-	-	-	-
3.696 ($\frac{3}{16}$)	7.144($\frac{9}{32}$)	3.96(.156)	-	-	-	-	-	-	-	-
	7.144($\frac{9}{32}$)	4.78(.188)	JP-2 $\frac{1}{2}$ 3-F	-	-	-	-	-	-	-
	7.144($\frac{9}{32}$)	6.35(.250)	-	-	-	-	-	-	-	-
4.762 ($\frac{1}{4}$)	7.144($\frac{9}{32}$)	7.92(.312)	-	-	-	-	-	-	-	-
	8.731($\frac{11}{32}$)	6.35(.250)	-	-	-	-	-	-	-	-
	8.731($\frac{11}{32}$)	9.52(.375)	J-36	-	-	-	MJ-361	-	-	-
6.350 ($\frac{1}{4}$)	8.731($\frac{11}{32}$)	9.52(.375)	-	-	-	-	-	-	-	-
	11.112($\frac{7}{16}$)	6.35(.250)	-	BA 44	-	-	-	-	-	-
	11.112($\frac{7}{16}$)	7.92(.312)	J-45	BA 45Z	-	-	MJ-451	BAM 45	-	-
	11.112($\frac{7}{16}$)	7.92(.312)	-	-	-	-	-	-	-	-
	11.112($\frac{7}{16}$)	9.52(.375)	-	-	-	-	-	-	-	-
	11.112($\frac{7}{16}$)	11.13(.438)	J-47	BA 47Z	-	-	MJ-471	BAM 47	-	-
7.938 ($\frac{5}{16}$)	11.112($\frac{7}{16}$)	11.13(.438)	-	-	-	-	-	-	-	-
	12.700($\frac{1}{2}$)	7.92(.312)	J-55	BA 55Z	-	-	-	BAM 55	-	-
	12.700($\frac{1}{2}$)	7.92(.312)	-	-	-	-	-	-	-	-
	12.700($\frac{1}{2}$)	9.52(.375)	JT-56	BA 56Z	-	-	-	BAM 56	-	-
	12.700($\frac{1}{2}$)	9.52(.375)	-	-	-	-	-	-	-	-
	12.700($\frac{1}{2}$)	11.13(.438)	J-57	BA 57Z	-	-	MJ-571	BAM 57	-	-
	12.700($\frac{1}{2}$)	11.13(.438)	-	-	-	-	-	-	-	-
	12.700($\frac{1}{2}$)	11.13(.438)	JTT-57	-	-	-	-	-	-	-
	12.700($\frac{1}{2}$)	14.27(.562)	JTT-59	BA 59Z	-	-	-	BAM 59	-	-
	12.700($\frac{1}{2}$)	14.27(.562)	-	-	-	-	-	-	-	-
	14.288($\frac{9}{16}$)	11.13(.438)	-	-	JH-57	BHA 57Z	-	-	MJH-571	BHAM 57
	14.288($\frac{9}{16}$)	11.13(.438)	-	-	-	-	-	-	-	-
14.288($\frac{9}{16}$)	14.27(.562)	-	-	-	-	-	-	-	-	

총롤러형			사양					적합한 Inner Ring	
Koyo	IKO	Koyo	Koyo		IKO	IKO	허용 회전수	Koyo	IKO
개방형	한쪽폐쇄형	한쪽폐쇄형	동정격하중 C lbf	정적격하중 C ₀ lbf	허용 회전수 rpm ⁽¹⁾	동정격하중 C N	정적격하중 C ₀ N	허용 회전수 rpm ⁽¹⁾	
-	-	-	201	137	51,000	-	-	-	-
B-24	-	-	388	366	13,000	-	-	-	-
-	YB 2.52.5	-	-	-	-	1,350	1,220	40,000	-
-	-	-	206	144	47,000	-	-	-	-
B-2 $\frac{1}{2}$ 4	YB 2.54	-	447	453	11,000	2,320	2,440	40,000	-
B-2 $\frac{1}{2}$ 5	-	-	581	634	11,000	-	-	-	-
B-34	YB 34	M-341	498	480	11,000	2,770	2,700	30,000	-
-	-	-	513	432	38,000	-	-	-	-
B-36	-	M-361	846	948	11,000	-	-	-	-
B-44	-	M-441	615	591	10,000	1,770	1,390	55,000	-
-	-	-	498	391	30,000	1,510	1,120	55,000	-
B-45	YB 45	M-451	799	826	10,000	4,450	4,870	25,000	-
B-46	-	-	1,020	1,130	10,000	-	-	-	-
-	-	-	764	676	30,000	2,650	2,310	55,000	-
B-47	YB 47	M-471	1,240	1,450	10,000	6,320	7,650	25,000	-
-	-	-	540	453	28,000	1,880	1,560	45,000	-
B-55	YB 55	M-551	918	1,030	8,300	5,110	6,090	20,000	-
-	-	-	540	453	18,000	2,620	2,390	45,000	-
B-56	-	-	1,180	1,430	8,300	-	-	-	-
-	-	-	906	881	28,000	3,310	3,220	45,000	-
B-57	-	M-571	1,420	1,810	8,300	-	-	-	-
-	-	-	540	453	18,000	-	-	-	-
-	-	-	906	881	18,000	4,190	4,360	45,000	-
B-59	-	-	1,880	2,600	8,300	-	-	-	-
-	-	-	1,040	845	22,000	4,150	3,730	45,000	-
BH-57	-	MH-571	1,580	1,650	12,000	-	-	-	-
BH-59	-	-	2,130	2,420	12,000	-	-	-	-

(1) JT, JTT는 그리스 주입시 허용회전수이며, 그 외에는 오일주입시 허용회전수입니다.

1.1 Shell Type Needle Roller Bearings

인치계열

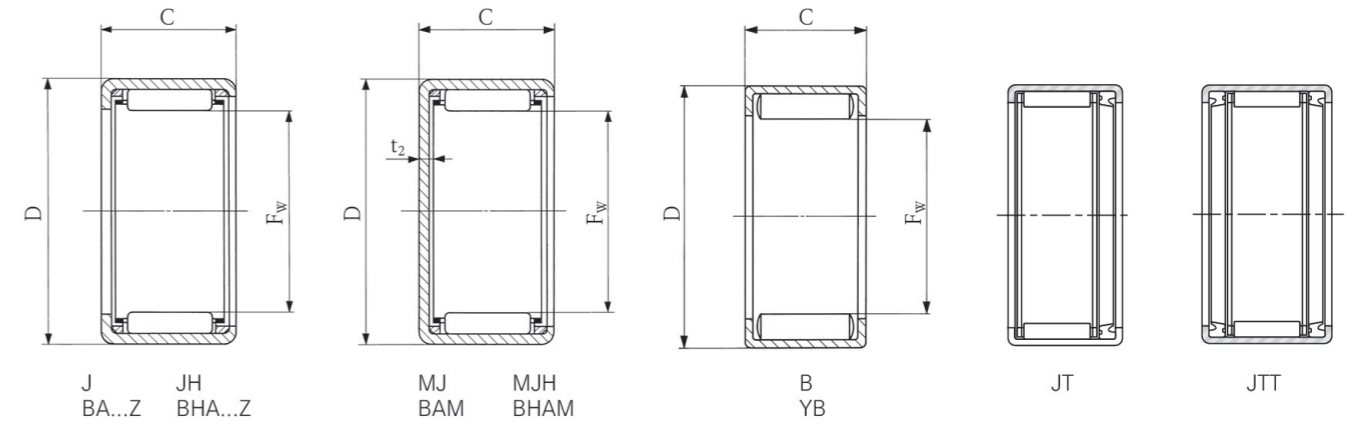

내경 F _w (mm)	외경 D (mm)	폭 C (mm)	유지기형							
			Koyo		IKO		Koyo		IKO	
			개방형1		개방형2		한쪽폐쇄형1		한쪽폐쇄형2	
9.525 ($\frac{3}{8}$)	14.288($\frac{9}{16}$)	6.35(.250)	-	-	-	-	-	-	-	-
	14.288($\frac{9}{16}$)	7.92(.312)	J-65	BA 65Z	-	-	MJ-651	BAM 65	-	-
	14.288($\frac{9}{16}$)	7.92(.312)	-	-	-	-	-	-	-	-
	14.288($\frac{9}{16}$)	9.52(.375)	J-66	BA 66Z	-	-	MJ-661	BAM 66	-	-
	14.288($\frac{9}{16}$)	9.52(.375)	-	-	-	-	-	-	-	-
	14.288($\frac{9}{16}$)	9.52(.375)	JT-66	-	-	-	-	-	-	-
	14.288($\frac{9}{16}$)	11.13(.438)	JTT-67	-	-	-	-	-	-	-
	14.288($\frac{9}{16}$)	11.13(.438)	-	-	-	-	-	-	-	-
	14.288($\frac{9}{16}$)	12.70(.500)	J-68	BA 68Z	-	-	MJ-681	BAM 68	-	-
	14.288($\frac{9}{16}$)	12.70(.500)	-	-	-	-	-	-	-	-
	14.288($\frac{9}{16}$)	14.27(.562)	JT-69	BA 69Z	-	-	-	BAM 69	-	-
	14.288($\frac{9}{16}$)	14.27(.562)	-	-	-	-	-	-	-	-
	14.288($\frac{9}{16}$)	15.88(.625)	-	BA 610Z	-	-	-	BAM 610	-	-
	14.288($\frac{9}{16}$)	15.88(.625)	-	-	-	-	-	-	-	-
	15.875($\frac{5}{8}$)	12.70(.500)	-	-	JH-68	BHA 68Z	-	-	-	BHAM 68
15.875($\frac{5}{8}$)	12.70(.500)	-	-	-	-	-	-	-	-	
11.112 ($\frac{7}{16}$)	15.875($\frac{5}{8}$)	9.52(.375)	-	BA 76Z	-	-	-	BAM 76	-	-
	15.875($\frac{5}{8}$)	11.13(.438)	-	BA 77Z	-	-	-	BAM 77	-	-
	15.875($\frac{5}{8}$)	12.70(.500)	J-78	BA 78Z	-	-	MJ-781	BAM 78	-	-
	15.875($\frac{5}{8}$)	12.70(.500)	-	-	-	-	-	-	-	-
	15.875($\frac{5}{8}$)	15.88(.625)	-	BA 710Z	-	-	-	BAM 710	-	-
	17.462($\frac{11}{16}$)	12.70(.500)	-	-	JH-78	BHA 78Z	-	-	-	BHAM 78
	17.462($\frac{11}{16}$)	12.70(.500)	-	-	-	-	-	-	-	-

총롤러형			사양						적합한 Inner Ring	
Koyo	IKO	Koyo	Koyo			IKO			Koyo	IKO
개방형	한쪽폐쇄형	동정격하중 C lbf	정적격하중 C ₀ lbf	허용 회전수 rpm ⁽¹⁾	동정격하중 C N	정적격하중 C ₀ N	허용 회전수 rpm ⁽¹⁾	적합한 Inner Ring		
								Koyo	IKO	
-	YB 64	-	-	-	4,470	5,360	16,000	-	-	
-	-	-	615	560	27,000	2,220	2,010	40,000	-	
B-65	-	M-651	1,020	1,240	7,100	-	-	-	-	
-	-	-	794	778	27,000	3,090	3,080	40,000	-	
B-66	YB 66	M-661	1,310	1,700	7,100	6,920	9,410	16,000	-	
-	-	-	615	560	18,000	-	-	-	-	
-	-	-	615	560	18,000	-	-	-	-	
B-67	-	-	1,580	2,180	7,100	-	-	-	-	
-	-	-	1,170	1,290	27,000	4,190	4,560	40,000	IRA-3	
B-68	YB 68	M-681	1,840	2,650	7,100	9,210	13,600	16,000	IRA-3	
-	-	-	1,170	1,290	18,000	4,940	5,630	40,000	-	
B-69	-	-	2,100	3,130	7,100	-	-	-	-	
-	-	-	-	-	-	5,660	6,700	40,000	-	
B-610	YB 610	M-6101	2,340	3,590	7,100	11,300	17,800	16,000	-	
-	-	-	1,480	1,370	20,000	4,880	4,740	40,000	-	
BH-68	-	-	2,100	2,460	10,000	-	-	-	-	
B-76	-	-	1,430	1,990	6,300	3,290	3,470	35,000	-	
B-77	-	-	1,730	2,540	6,300	4,150	4,680	35,000	-	
-	-	-	1,430	1,730	26,000	4,460	5,130	35,000	IRA-4	
B-78	YB 78	M-781	2,020	3,100	6,300	10,100	15,900	14,000	IRA-4	
B-710	-	-	2,550	4,200	6,300	6,020	7,550	35,000	-	
-	-	-	1,860	1,880	19,000	5,680	5,970	35,000	-	
BH-78	YBH 78	-	2,320	2,870	8,800	12,500	15,800	14,000	-	

(1) JT, JTT는 그리스 주입시 허용회전수이며, 그 외에는 오일주입시 허용회전수입니다.

1.1 Shell Type Needle Roller Bearings

인치계열

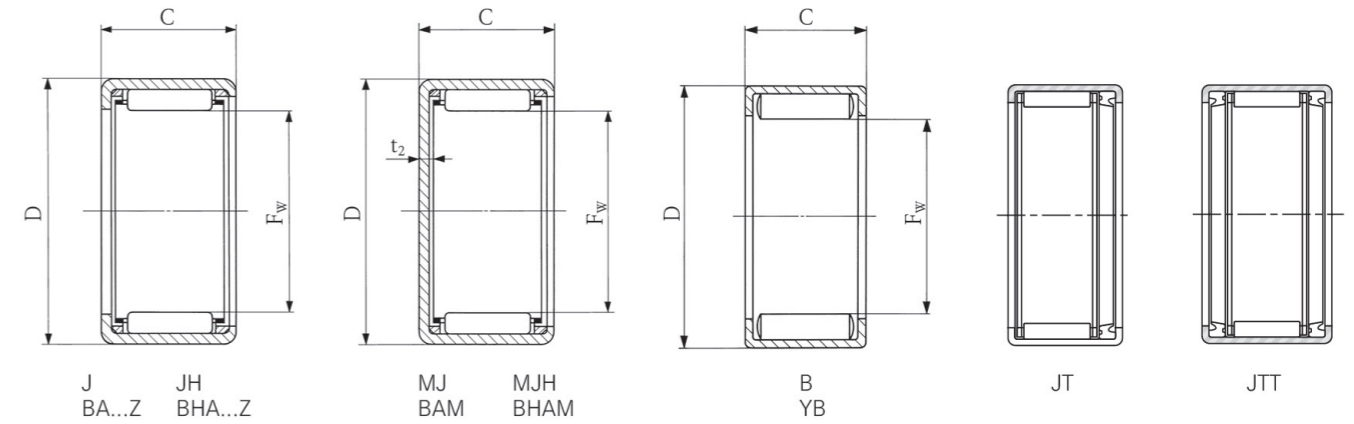

내경 F _w (mm)	외경 D (mm)	폭 C (mm)	유지기형							
			Koyo		IKO		Koyo		IKO	
			개방형1		개방형2		한쪽폐쇄형1		한쪽폐쇄형2	
12.700 (1/2)	17.462(1/6)	6.35(.250)	-	-	-	-	-	-	-	-
	17.462(1/6)	7.92(.312)	J-85	BA 85Z	-	-	MJ-851	BAM 85	-	-
	17.462(1/6)	7.92(.312)	-	-	-	-	-	-	-	-
	17.462(1/6)	9.52(.375)	J-86	BA 86Z	-	-	MJ-861	BAM 86	-	-
	17.462(1/6)	9.52(.375)	-	-	-	-	-	-	-	-
	17.462(1/6)	9.52(.375)	JT-86	-	-	-	-	-	-	-
	17.462(1/6)	11.13(.438)	JTT-87	BA 87Z	-	-	-	BAM 87	-	-
	17.462(1/6)	11.13(.438)	-	-	-	-	-	-	-	-
	17.462(1/6)	12.70(.500)	J-88	BA 88Z	-	-	MJ-881	BAM 88	-	-
	17.462(1/6)	12.70(.500)	-	-	-	-	-	-	-	-
	17.462(1/6)	14.27(.562)	JT-89	-	-	-	-	-	-	-
	17.462(1/6)	15.88(.625)	JTT-810	BA 810Z	-	-	-	BAM 810	-	-
	17.462(1/6)	15.88(.625)	-	-	-	-	-	-	-	-
	17.462(1/6)	19.05(.750)	J-812	BA 812Z	-	-	-	BAM 812	-	-
	17.462(1/6)	19.05(.750)	-	-	-	-	-	-	-	-
	17.462(1/6)	22.22(.870)	JTT-814	-	-	-	-	-	-	-
	19.050(3/4)	11.13(.438)	-	-	JH-87	BHA 87Z	-	-	MJH-871	BHAM 87
	19.050(3/4)	11.13(.438)	-	-	-	-	-	-	-	-
	19.050(3/4)	12.70(.500)	-	-	JH-88	BHA 88Z	-	-	MJH-881	BHAM 88
	19.050(3/4)	12.70(.500)	-	-	-	-	-	-	-	-
	19.050(3/4)	15.88(.625)	-	-	-	BHA 810Z	-	-	-	BHAM 810
	19.050(3/4)	15.88(.625)	-	-	-	-	-	-	-	-
	19.050(3/4)	19.05(.750)	-	-	JH-812	BHA 812Z	-	-	-	BHAM 812
	19.050(3/4)	19.05(.750)	-	-	-	-	-	-	-	-

총roller형			사양						적합한 Inner Ring	
Koyo	IKO	Koyo	Koyo		IKO	IKO	허용 회전수	Koyo	IKO	
개방형	한쪽폐쇄형	한쪽폐쇄형	동정격하중 C lbf	정적격하중 C ₀ lbf	허용 회전수 rpm ⁽¹⁾	동정격하중 C N	정적격하중 C ₀ N	허용 회전수 rpm ⁽¹⁾	적합한 Inner Ring Koyo	적합한 Inner Ring IKO
-	YB 84	-	-	-	-	5,260	7,150	12,000	-	-
-	-	-	778	824	25,000	2,490	2,510	30,000	-	-
B-85	-	M-851	1,200	1,650	5,600	-	-	-	-	-
-	-	-	1,050	1,210	25,000	3,470	3,850	30,000	-	-
B-86	YB 86	M-861	1,540	2,280	5,600	8,150	12,600	12,000	-	-
-	-	-	778	824	15,000	-	-	-	-	-
-	-	-	778	824	15,000	4,380	5,190	30,000	-	-
B-87	YB 87	M-871	1,870	2,920	5,600	9,530	15,300	12,000	-	-
-	-	-	1,420	1,290	25,000	4,710	5,700	30,000	IRA-5	IRB 58
B-88	YB 88	M-881	2,170	3,530	5,600	10,800	18,100	12,000	IRA-5	IRB 58
-	-	-	1,420	1,780	15,000	-	-	-	-	-
-	-	-	1,420	1,780	15,000	6,350	8,380	30,000	-	-
B-810	YB 810	M-8101	2,750	4,790	5,600	13,400	23,700	12,000	-	-
-	-	-	2,300	3,310	25,000	7,840	11,000	30,000	-	-
B-812	YB 812	M-8121	3,300	6,060	5,600	15,800	29,300	12,000	-	-
-	-	-	2,300	3,310	15,000	-	-	-	-	-
-	-	-	1,440	1,390	19,000	5,670	6,120	30,000	-	-
BH-87	-	-	2,130	2,650	7,900	-	-	-	-	-
-	-	-	1,700	1,730	19,000	6,040	6,650	30,000	-	IRB 58
BH-88	-	-	2,510	3,280	7,900	-	-	-	-	-
-	-	-	-	-	-	8,830	10,900	30,000	-	-
BH-810	YBH 810	-	3,230	4,540	7,900	16,300	23,500	12,000	-	-
-	-	-	2,770	3,240	19,000	11,100	14,500	30,000	-	-
BH-812	-	MH-8121	3,910	5,790	7,900	-	-	-	-	-

(1) JT, JTT는 그리스 주입시 허용회전수이며, 그 외에는 오일주입시 허용회전수입니다.

1.1 Shell Type Needle Roller Bearings

인치계열

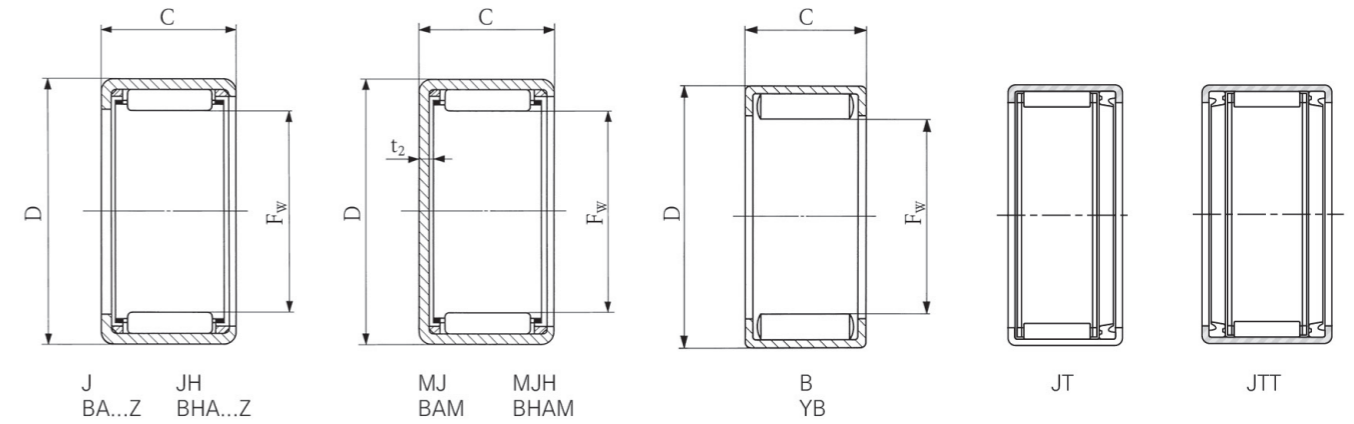

내경 F _w (mm)	외경 D (mm)	폭 C (mm)	유지기형									
			Koyo		IKO		Koyo		IKO			
			개방형1		개방형2		한쪽폐쇄형1		한쪽폐쇄형2			
14.288 (⁵ / ₁₆)	19.050(³ / ₄)	7.92 (.250)	-	BA 95Z	-	-	-	-	BAM 95	-	-	
	19.050(³ / ₄)	7.92 (.312)	-	-	-	-	-	-	-	-	-	
	19.050(³ / ₄)	9.52 (.375)	-	BA 96Z	-	-	-	-	BAM 96	-	-	
	19.050(³ / ₄)	9.52 (.375)	-	-	-	-	-	-	-	-	-	
	19.050(³ / ₄)	11.13 (.438)	J-97	BA 97Z	-	-	-	MJ-971	BAM 97	-	-	
	19.050(³ / ₄)	11.13 (.438)	-	-	-	-	-	-	-	-	-	
	19.050(³ / ₄)	12.70 (.500)	J-98	BA 98Z	-	-	-	MJ-981	BAM 98	-	-	
	19.050(³ / ₄)	12.70 (.500)	-	-	-	-	-	-	-	-	-	
	19.050(³ / ₄)	14.27 (.562)	JT-99	-	-	-	-	-	-	-	-	
	19.050(³ / ₄)	15.88 (.625)	J-910	BA 910Z	-	-	-	-	BAM 910	-	-	
	19.050(³ / ₄)	15.88 (.625)	-	-	-	-	-	-	-	-	-	
	19.050(³ / ₄)	15.88 (.625)	JTT-910	-	-	-	-	-	-	-	-	
	19.050(³ / ₄)	19.05 (.750)	JTT-912	BA 912Z	-	-	-	-	BAM 912	-	-	
	19.050(³ / ₄)	19.05 (.750)	-	-	-	-	-	-	-	-	-	
	20.638(¹³ / ₁₆)	12.70 (.500)	-	-	JH-98	BHA 98Z	-	-	MJH-981	BHAM 98	-	-
	20.638(¹³ / ₁₆)	12.70 (.500)	-	-	-	-	-	-	-	-	-	
	20.638(¹³ / ₁₆)	15.88 (.625)	-	-	-	BHA 910Z	-	-	-	-	BHAM 910	
	20.638(¹³ / ₁₆)	15.88 (.625)	-	-	-	-	-	-	-	-	-	
	20.638(¹³ / ₁₆)	19.05 (.750)	-	-	-	BHA 912Z	-	-	-	-	BHAM 912	
	20.638(¹³ / ₁₆)	19.05 (.750)	-	-	-	-	-	-	-	-	-	

총롤러형			사양						적합한 Inner Ring	
Koyo	IKO	Koyo	Koyo		IKO	IKO	허용 회전수	Koyo	IKO	
개방형	한쪽폐쇄형	한쪽폐쇄형	동정격하중 C lbf	정적격하중 C ₀ lbf	허용 회전수 rpm ⁽¹⁾	동정격하중 C N	정적격하중 C ₀ N	허용 회전수 rpm ⁽¹⁾		
-	-	-	-	-	-	2,760	2,970	30,000	-	-
B-95	-	M-951	1,290	1,870	5,000	-	-	-	-	-
-	-	-	-	-	-	3,850	4,560	30,000	-	-
B-96	-	M-961	1,650	2,570	5,000	-	-	-	-	-
-	-	-	1,230	1,530	25,000	4,860	6,140	30,000	-	-
B-97	-	M-971	1,990	3,280	5,000	-	-	-	-	-
-	-	-	1,400	1,800	25,000	5,220	6,740	30,000	IR-68	IRB 68
B-98	YB 98	M-981	2,320	3,990	5,000	11,600	20,400	11,000	IR-68	IRB 68
-	-	-	1,400	1,800	14,000	-	-	-	-	-
-	-	-	1,310	1,620	25,000	7,050	9,910	30,000	-	-
B-910	YB 910	M-9101	2,940	5,400	5,000	14,300	26,700	11,000	-	-
-	-	-	1,400	1,800	14,000	-	-	-	-	-
-	-	-	1,840	2,560	14,000	8,690	13,000	30,000	IR-612, IRA-6	IRB 612
B-912	YB 912	M-9121	3,520	6,820	5,000	16,800	33,000	11,000	IR-612, IRA-6	IRB 612
-	-	-	1,800	1,910	18,000	6,380	7,330	30,000	-	IRB 68
BH-98	-	-	2,690	3,700	7,100	-	-	-	-	-
-	-	-	-	-	-	9,280	11,900	30,000	-	-
BH-910	-	-	3,460	5,110	7,100	-	-	-	-	-
-	-	-	-	-	-	11,600	15,900	30,000	-	IRB 612
BH-912	-	-	4,190	6,520	7,100	-	-	-	-	-

(1) JT, JTT는 그리스 주입시 허용회전수이며, 그 외에는 오일주입시 허용회전수입니다.

1.1 Shell Type Needle Roller Bearings

인치계열

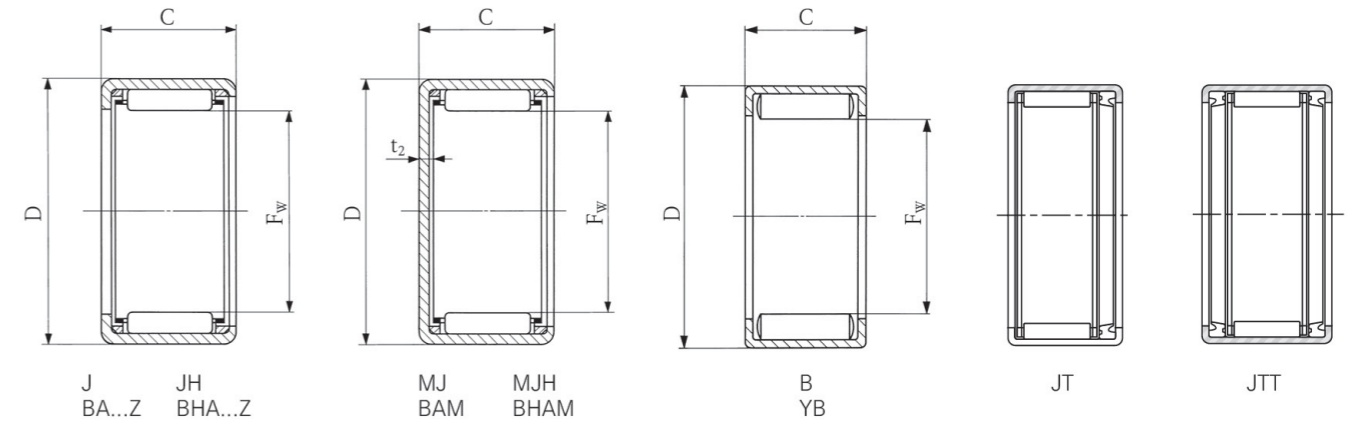

내경 F _w (mm)	외경 D (mm)	폭 C (mm)	유지기형							
			Koyo		IKO		Koyo		IKO	
			개방형1		개방형2		한쪽폐쇄형1		한쪽폐쇄형2	
15.875 ($\frac{5}{8}$)	20.638($\frac{13}{16}$)	7.92 (.312)	-	BA 105Z	-	-	-	BAM 105	-	-
	20.638($\frac{13}{16}$)	7.92 (.312)	-	-	-	-	-	-	-	-
	20.638($\frac{13}{16}$)	11.13 (.438)	-	BA 107Z	-	-	-	BAM 107	-	-
	20.638($\frac{13}{16}$)	11.13 (.438)	-	-	-	-	-	-	-	-
	20.638($\frac{13}{16}$)	12.70 (.500)	J-108	BA 108Z	-	-	MJ-1081	BAM 108	-	-
	20.638($\frac{13}{16}$)	12.70 (.500)	-	-	-	-	-	-	-	-
	20.638($\frac{13}{16}$)	14.27 (.562)	JT-109	-	-	-	-	-	-	-
	20.638($\frac{13}{16}$)	15.88 (.625)	J-1010	BA 1010Z	-	-	MJ-10101	BAM 1010	-	-
	20.638($\frac{13}{16}$)	15.88 (.625)	JTT-1010	-	-	-	-	-	-	-
	20.638($\frac{13}{16}$)	15.88 (.625)	-	-	-	-	-	-	-	-
	20.638($\frac{13}{16}$)	19.05 (.750)	J-1012	BA 1012Z	-	-	MJ-10121	BAM 1012	-	-
	20.638($\frac{13}{16}$)	19.05 (.750)	-	-	-	-	-	-	-	-
	20.638($\frac{13}{16}$)	19.05 (.750)	JTT-1012	-	-	-	-	-	-	-
	20.638($\frac{13}{16}$)	22.22 (.875)	JTT-1014	BA 1014Z	-	-	-	BAM 1014	-	-
	20.638($\frac{13}{16}$)	25.40 (1.000)	-	BA 1016Z	-	-	-	BAM 1016	-	-
	22.225($\frac{7}{8}$)	12.70 (.500)	-	-	-	BHA 108Z	-	-	-	BHAM 108
	22.225($\frac{7}{8}$)	12.70 (.500)	-	-	-	-	-	-	-	-
	22.225($\frac{7}{8}$)	15.88 (.625)	-	-	JH-1010	BHA 1010Z	-	-	MJH-10101	BHAM 1010
	22.225($\frac{7}{8}$)	15.88 (.625)	-	-	-	-	-	-	-	-
	22.225($\frac{7}{8}$)	19.05 (.750)	-	-	-	BHA 1012Z	-	-	-	BHAM 1012
	22.225($\frac{7}{8}$)	19.05 (.750)	-	-	-	-	-	-	-	-
	22.225($\frac{7}{8}$)	25.40 (1.000)	-	-	JH-1016	BHA 1016Z	-	-	MJH-10161	BHAM 1016
	22.225($\frac{7}{8}$)	25.40 (1.000)	-	-	-	-	-	-	-	-

총롤러형			사양						적합한 Inner Ring	
Koyo	IKO	Koyo	Koyo		IKO	IKO	허용 회전수	Koyo	IKO	
개방형	한쪽폐쇄형	한쪽폐쇄형	동정격하중	정적격하중	허용 회전수	동정격하중	정적격하중	rpm ⁽¹⁾	rpm ⁽¹⁾	
			C lbf	C ₀ lbf		C N	C ₀ N			
-	-	-	-	-	-	2,870	3,220	25,000	-	-
B-105	YB 105	M-1051	1,360	2,080	4,500	7,580	12,200	9,500	-	-
-	-	-	-	-	-	5,040	6,660	25,000	-	-
B-107	-	M-1071	2,110	3,650	4,500	-	-	-	-	-
-	-	-	1,510	2,050	21,000	5,420	7,310	25,000	IR-68-1	IRB 68-1
B-108	YB 108	M-1081	2,450	4,430	4,500	12,300	22,700	9,500	IR-68-1	IRB 68-1
-	-	-	1,510	2,050	12,000	-	-	-	-	-
-	-	-	1,980	2,910	21,000	7,320	10,700	25,000	-	-
-	-	-	1,510	2,050	12,000	-	-	-	-	-
B-1010	-	M-10101	3,110	6,000	4,500	-	-	-	-	-
-	-	-	2,640	4,240	21,000	9,020	14,100	25,000	IRA-7, IR-612-1	IRB 612-1
B-1012	YB 1012	M-10121	3,720	7,570	4,500	17,800	36,600	9,500	IRA-7, IR-612-1	IRB 612-1
-	-	-	1,980	2,910	12,000	-	-	-	IRA-7, IR-612-1	-
-	-	-	2,640	4,240	12,000	10,700	17,500	25,000	-	IRB 714
-	-	-	-	-	-	12,300	20,800	25,000	-	IRB 716
-	-	-	-	-	-	6,680	8,020	25,000	-	IRB 68-1
BH-108	YBH 108	MH-1081	2,860	4,110	6,500	15,000	22,400	9,500	-	IRB 68-1
-	-	-	2,600	3,170	21,000	10,200	13,800	25,000	-	-
BH-1010	-	-	3,680	5,680	6,500	-	-	-	-	-
-	-	-	-	-	-	12,700	18,500	25,000	-	IRB 612-1
BH-1012	-	-	4,450	7,250	6,500	-	-	-	IRA-7, IR-612-1	-
-	-	-	4,450	6,320	21,000	17,400	27,600	25,000	-	IRB 716
BH-1016	-	-	5,890	10,400	6,500	-	-	-	-	-

(1) JT, JTT는 그리스 주입시 허용회전수이며, 그 외에는 오일주입시 허용회전수입니다.

1.1 Shell Type Needle Roller Bearings

인치계열

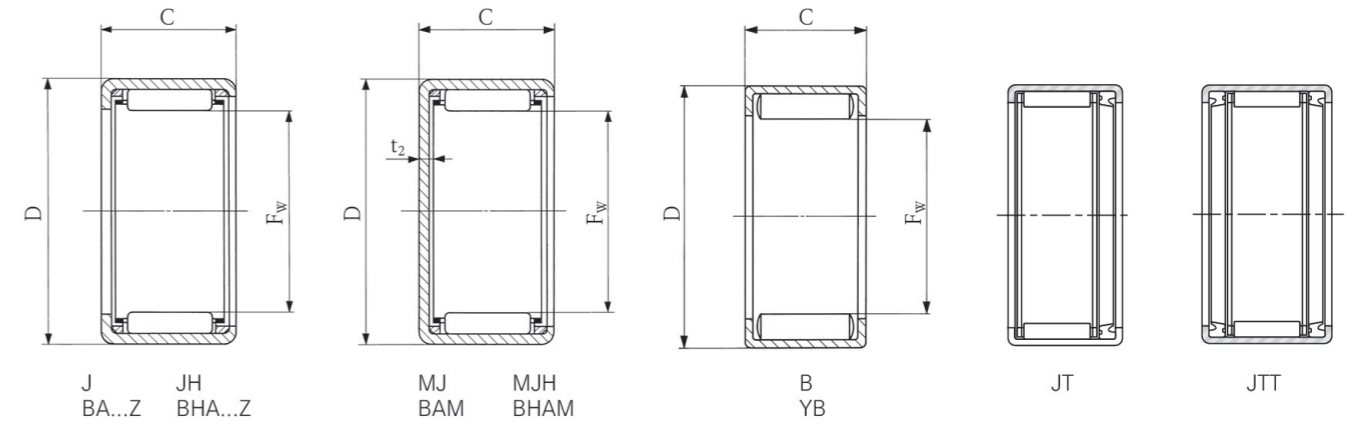

내경 Fw (mm)	외경 D (mm)	폭 C (mm)	유지기형							
			Koyo		IKO		Koyo		IKO	
			개방형1		개방형2		한쪽폐쇄형1		한쪽폐쇄형2	
17.462 ($\frac{7}{8}$)	22.225($\frac{7}{8}$)	9.52 (.375)	-	BA 116Z	-	-	-	BAM 116	-	-
	22.225($\frac{7}{8}$)	12.70 (.500)	-	BA 118Z	-	-	-	BAM 118	-	-
	22.225($\frac{7}{8}$)	15.88 (.625)	-	BA 1110Z	-	-	-	BAM 1110	-	-
	22.225($\frac{7}{8}$)	19.05 (.750)	J-1112	BA 1112Z	-	-	MJ-11121	BAM 1112	-	-
	22.225($\frac{7}{8}$)	19.05 (.750)	-	-	-	-	-	-	-	-
	22.225($\frac{7}{8}$)	22.22 (.875)	JTT-1114	-	-	-	-	-	-	-
	23.812($\frac{15}{16}$)	11.13 (.438)	-	-	-	BHA 117Z	-	-	-	BHAM 117
	23.812($\frac{15}{16}$)	12.70 (.500)	-	-	-	BHA 118Z	-	-	-	BHAM 118
	23.812($\frac{15}{16}$)	15.88 (.625)	-	-	JH-1110	BHA 1110Z	-	-	MJH-11101	BHAM 1110
	23.812($\frac{15}{16}$)	15.88 (.625)	-	-	-	-	-	-	-	-
	23.812($\frac{15}{16}$)	19.05 (.750)	-	-	JH-1112	BHA 1112Z	-	-	-	BHAM 1112
23.812($\frac{15}{16}$)	19.05 (.750)	-	-	-	-	-	-	-	-	
19.050 ($\frac{3}{4}$)	25.400(1)	6.35 (.250)	-	-	-	-	-	-	-	-
	25.400(1)	9.52 (.375)	J-126	BA 126Z	-	-	-	BAM 126	-	-
	25.400(1)	9.52 (.375)	-	-	-	-	-	-	-	-
	25.400(1)	12.70 (.500)	J-128	BA 128Z	-	-	-	BAM 128	-	-
	25.400(1)	12.70 (.500)	-	-	-	-	-	-	-	-
	25.400(1)	14.27 (.562)	JT-129	-	-	-	-	-	-	-
	25.400(1)	15.88 (.625)	J-1210	BA 1210Z	-	-	MJ-12101	BAM 1210	-	-
	25.400(1)	15.88 (.625)	-	-	-	-	-	-	-	-
	25.400(1)	15.88 (.625)	JTT-1210	-	-	-	-	-	-	-
	25.400(1)	17.48 (.688)	JT-1211	-	-	-	-	-	-	-
	25.400(1)	19.05 (.750)	J-1212	BA 1212Z	-	-	MJ-12121	BAM 1212	-	-
	25.400(1)	19.05 (.750)	-	-	-	-	-	-	-	-
	25.400(1)	20.62 (.812)	JT-1213	-	-	-	-	-	-	-
	25.400(1)	22.22 (.875)	JTT-1214	BA 1214Z	-	-	-	BAM 1214	-	-
	25.400(1)	25.40 (1.000)	-	BA 1216Z	-	-	-	BAM 1216	-	-
	26.988(1 $\frac{1}{16}$)	19.05 (.750)	-	-	JH-1212	BHA 1212Z	-	-	MJH-12121	BHAM 1212

총롤러형			사양						적합한 Inner Ring		
Koyo	IKO	Koyo	Koyo		IKO	허용 회전수	동정격하중	정적격하중	허용 회전수	Koyo	IKO
개방형	한쪽폐쇄형	한쪽폐쇄형	동정격하중 C lbf	정적격하중 C ₀ lbf	rpm ⁽¹⁾	C N	C ₀ N	rpm ⁽¹⁾			
B-116	-	M-1161	1,840	3,140	4,200	4,530	5,980	25,000	-	IRB 86	
B-118	-	M-1181	2,580	4,880	4,200	6,140	8,850	25,000	-	IRB 88	
B-1110	-	M-11101	3,270	6,610	4,200	8,280	13,000	25,000	-	-	
-	-	-	2,800	4,700	19,000	10,200	17,000	25,000	-	IRB 812	
B-1112	YB 1112	M-11121	3,920	8,340	4,200	18,700	40,300	8,500	-	IRB 812	
-	-	-	2,800	4,700	11,000	-	-	-	-	-	
BH-117	-	-	2,560	3,650	6,000	6,860	8,530	25,000	-	-	
-	-	-	-	-	-	7,320	9,270	25,000	-	IRB 88	
-	-	-	2,710	3,420	19,000	10,500	14,900	25,000	-	-	
BH-1110	-	MH-11101	3,890	6,250	6,000	-	-	-	-	-	
-	-	-	3,630	4,990	19,000	13,200	19,900	25,000	-	IRB 812	
BH-1112	-	-	4,700	7,980	6,000	-	-	-	-	-	
-	YB 124	-	-	-	-	7,820	10,200	8,000	-	-	
-	-	-	1,460	1,580	18,000	5,040	5,850	20,000	-	-	
B-126	-	M-1261	2,180	3,050	5,600	-	-	-	-	-	
-	-	-	2,230	2,740	18,000	6,910	8,780	20,000	IR-88	IRB 88-1	
B-128	YB 128	M-1281	3,170	4,940	5,600	16,600	26,900	8,000	IR-88	IRB 88-1	
-	-	-	2,230	2,740	10,000	-	-	-	-	-	
-	-	-	2,810	3,670	18,000	9,500	13,200	20,000	-	IRB 810-1	
B-1210	YB 1210	M-12101	4,080	6,820	5,600	20,500	35,300	8,000	-	IRB 810-1	
-	-	-	2,230	2,740	10,000	-	-	-	-	-	
-	-	-	2,810	3,670	10,000	-	-	-	-	-	
-	-	-	3,490	4,860	18,000	11,900	17,700	20,000	IR-812, IRA-8	IRB 812-1	
B-1212	YB 1212	M-12121	4,930	8,710	5,600	24,100	43,400	8,000	IR-812, IRA-8	IRB 812-1	
-	-	-	3,490	4,860	10,000	-	-	-	-	-	
-	-	-	3,490	4,860	10,000	14,200	22,200	20,000	-	IRB 814-1	
-	-	-	-	-	-	16,300	26,500	20,000	-	IRB 816-1	
-	-	-	4,290	5,300	18,000	16,600	22,600	20,000	IR-812, IRA-8	IRB 812-1	

(1) JT, JTT는 그리스 주입시 허용회전수이며, 그 외에는 오일주입시 허용회전수입니다.

1.1 Shell Type Needle Roller Bearings

인치계열

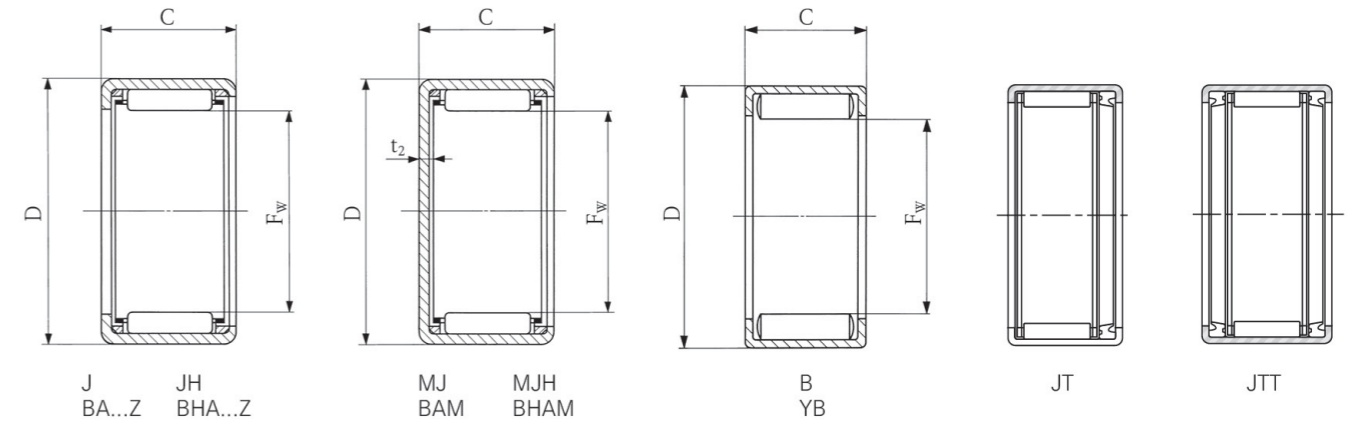

내경 F _w (mm)	외경 D (mm)	폭 C (mm)	유지기형								
			Koyo		IKO		Koyo		IKO		
			개방형1		개방형2		한쪽폐쇄형1		한쪽폐쇄형2		
20.638 ($\frac{1}{8}$)	26.988($1\frac{1}{16}$)	9.52(.375)	-	BA 136Z	-	-	-	-	BAM 136	-	-
	26.988($1\frac{1}{16}$)	9.52(.375)	-	-	-	-	-	-	-	-	-
	26.988($1\frac{1}{16}$)	12.70(.500)	-	BA 138Z	-	-	-	-	BAM 138	-	-
	26.988($1\frac{1}{16}$)	12.70(.500)	-	-	-	-	-	-	-	-	-
	26.988($1\frac{1}{16}$)	15.88(.625)	-	BA 1310Z	-	-	-	-	BAM 1310	-	-
	26.988($1\frac{1}{16}$)	19.05(.875)	-	BA 1312Z	-	-	-	-	BAM 1312	-	-
	26.988($1\frac{1}{16}$)	22.22(.875)	J-1314	BA 1314Z	-	-	-	-	BAM 1314	-	-
	26.988($1\frac{1}{16}$)	22.22(.875)	-	-	-	-	-	-	-	-	-
	26.988($1\frac{1}{16}$)	25.40(1.000)	-	BA 1316Z	-	-	-	-	BAM 1316	-	-
	26.988($1\frac{1}{16}$)	25.40(1.000)	-	-	-	-	-	-	-	-	-
	26.988($1\frac{1}{16}$)	31.75(1.250)	-	BA 1320Z	-	-	-	-	BAM 1320	-	-
	28.575($1\frac{1}{8}$)	12.70(.500)	-	-	-	BHA 138Z	-	-	-	-	BHAM 138
	28.575($1\frac{1}{8}$)	12.70(.500)	-	-	-	-	-	-	-	-	-
	28.575($1\frac{1}{8}$)	15.88(.625)	-	-	-	BHA 1310Z	-	-	-	-	BHAM 1310
	28.575($1\frac{1}{8}$)	15.88(.625)	-	-	-	-	-	-	-	-	-
	28.575($1\frac{1}{8}$)	19.05(.750)	-	-	JH-1312	BHA 1312Z	-	-	-	MJH-13121	BHAM 1312
	28.575($1\frac{1}{8}$)	19.05(.750)	-	-	-	-	-	-	-	-	-

총롤러형			사양						적합한 Inner Ring	
Koyo	IKO	Koyo	Koyo		IKO	IKO		Koyo	IKO	
개방형	한쪽폐쇄형	한쪽폐쇄형	동정격하중	정적격하중	허용 회전수	동정격하중	정적격하중	허용 회전수		
			C lbf	C ₀ lbf		C N	C ₀ N			
-	-	-	-	-	-	5,230	6,300	19,000	-	-
B-136	YB 136	-	2,280	3,300	5,200	13,000	20,100	7,500	-	-
-	-	-	-	-	-	7,170	9,450	19,000	-	IRB 98
B-138	YB 138	M-1381	3,310	5,350	5,200	17,400	29,200	7,500	-	IRB 98
-	-	-	-	-	-	9,870	14,200	19,000	-	IRB 910
-	-	-	-	-	-	12,400	19,000	19,000	-	IRB 912
-	-	-	2,210	2,770	16,000	14,700	23,800	19,000	-	IRB 914
B-1314	-	M-13141	6,010	11,500	5,200	-	-	-	-	-
-	-	-	-	-	-	16,900	28,500	19,000	-	IRB 916
B-1316	-	M-13161	6,820	13,500	5,200	-	-	-	-	-
-	-	-	-	-	-	21,200	38,100	19,000	-	IRB 920
-	-	-	-	-	-	9,500	11,200	19,000	-	IRB 98
BH-138	-	MH-1381	3,340	4,680	6,300	-	-	-	-	-
-	-	-	-	-	-	13,800	18,200	19,000	-	IRB 910
BH-1310	YBH 1310	MH-13101	4,430	6,720	6,300	22,900	36,300	7,500	-	IRB 910
-	-	-	4,220	5,520	16,000	17,300	24,400	19,000	-	IRB 912
BH-1312	YBH 1312	MH-13121	5,440	8,760	6,300	27,200	45,300	7,500	-	IRB 912

(1) JT, JTT는 그리스 주입시 허용회전수이며, 그 외에는 오일주입시 허용회전수입니다.

1.1 Shell Type Needle Roller Bearings

인치계열

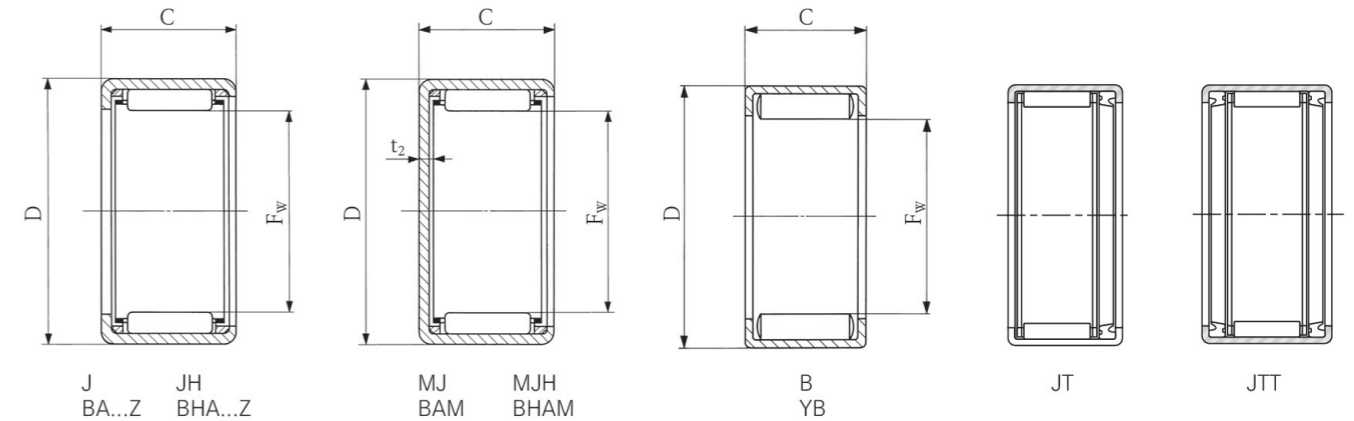

내경 F _w (mm)	외경 D (mm)	폭 C (mm)	유지기형							
			Koyo		IKO		Koyo		IKO	
			개방형1		개방형2		한쪽폐쇄형1		한쪽폐쇄형2	
22.225 ($\frac{9}{16}$)	28.575 (1 $\frac{1}{8}$)	9.52 (.375)	J-146	BA 146Z	-	-	-	BAM 146	-	-
	28.575 (1 $\frac{1}{8}$)	9.52 (.375)	-	-	-	-	-	-	-	-
	28.575 (1 $\frac{1}{8}$)	12.70 (.500)	J-148	BA 148Z	-	-	-	BAM 148	-	-
	28.575 (1 $\frac{1}{8}$)	12.70 (.500)	-	-	-	-	-	-	-	-
	28.575 (1 $\frac{1}{8}$)	14.27 (.562)	JT-149	-	-	-	-	-	-	-
	28.575 (1 $\frac{1}{8}$)	15.88 (.625)	JTT-1410	-	-	-	-	-	-	-
	28.575 (1 $\frac{1}{8}$)	19.05 (.750)	J-1412	BA 1412Z	-	-	MJ-14121	BAM 1412	-	-
	28.575 (1 $\frac{1}{8}$)	19.05 (.750)	-	-	-	-	-	-	-	-
	28.575 (1 $\frac{1}{8}$)	22.22 (.875)	-	BA 1414Z	-	-	-	BAM 1414	-	-
	28.575 (1 $\frac{1}{8}$)	25.40 (1.000)	J-1416	BA 1416Z	-	-	MJ-14161	BAM 1416	-	-
	28.575 (1 $\frac{1}{8}$)	25.40 (1.000)	-	-	-	-	-	-	-	-
	28.575 (1 $\frac{1}{8}$)	26.97 (1.062)	JT-1417	-	-	-	-	-	-	-
	28.575 (1 $\frac{1}{8}$)	28.58 (1.125)	-	BA 1418Z	-	-	-	BAM 1418	-	-
	28.575 (1 $\frac{1}{8}$)	28.58 (1.125)	-	-	-	-	-	-	-	-
	28.575 (1 $\frac{1}{8}$)	34.92 (1.375)	-	BA 1422Z	-	-	-	BAM 1422	-	-
	30.162 (1 $\frac{3}{16}$)	15.88 (.625)	-	-	-	BHA 1410Z	-	-	-	BHAM 1410
		15.88 (.625)	-	-	-	-	-	-	-	-
		19.05 (.750)	-	-	JH-1412	BHA 1412Z	-	-	MJH-14121	BHAM 1412
19.05 (.750)		-	-	-	-	-	-	-	-	
25.40 (1.000)		-	-	JH-1416	BHA 1416Z	-	-	MJH-14161	BHAM 1416	
25.40 (1.000)		-	-	-	-	-	-	-	-	
25.40 (1.000)		-	-	-	-	-	-	-	-	
23.812 ($\frac{19}{16}$)	12.70 (.500)	-	BA 158Z	-	-	-	BAM 158	-	-	
	12.70 (.500)	-	-	-	-	-	-	-	-	
	15.88 (.625)	-	BA 1510Z	-	-	-	BAM 1510	-	-	
	25.40 (1.000)	-	BA 1516Z	-	-	-	BAM 1516	-	-	
	25.40 (1.000)	-	-	-	-	-	-	-	-	

총롤러형			사양						적합한 Inner Ring		
Koyo	IKO	Koyo	Koyo		IKO	허용 회전수	동정격하중	정적격하중	허용 회전수	Koyo	IKO
개방형	한쪽폐쇄형	한쪽폐쇄형	동정격하중 C lbf	정적격하중 C ₀ lbf	허용 회전수 rpm ⁽¹⁾	동정격하중 C N	정적격하중 C ₀ N	허용 회전수 rpm ⁽¹⁾			
-	-	-	1,620	1,890	15,000	5,430	6,740	18,000	-	IRB 106	
B-146	-	M-1461	2,370	3,560	4,800	-	-	-	-	-	
-	-	-	2,460	3,260	15,000	7,440	10,100	18,000	-	IRB 108	
B-148	YB 148	M-1481	3,450	5,760	4,800	18,100	31,400	7,000	-	IRB 108	
-	-	-	2,760	3,770	8,700	-	-	-	-	-	
-	-	-	2,760	3,770	8,700	-	-	-	-	-	
-	-	-	4,020	6,110	15,000	12,800	20,400	18,000	IR-1012, IRA-10	IRB 1012	
B-1412	YB 1412	M-14121	5,370	10,200	4,800	26,300	50,700	7,000	IR-1012, IRA-10	IRB 1012	
-	-	-	-	-	-	15,300	25,500	18,000	-	IRB 1014	
-	-	-	5,320	8,760	15,000	17,600	30,500	18,000	IR-1016	IRB 1016	
B-1416	YB 1416	M-14161	7,100	14,600	4,800	33,800	70,200	7,000	IR-1016	IRB 1016	
-	-	-	5,320	8,760	8,700	-	-	-	-	-	
-	-	-	-	-	-	19,800	35,600	18,000	-	-	
B-1418	-	-	7,920	16,800	4,800	-	-	-	-	-	
-	-	-	-	-	-	24,100	45,700	18,000	-	IRB 1022	
-	-	-	-	-	-	14,300	19,500	18,000	-	-	
BH-1410	-	MH-14101	4,570	7,240	5,880	-	-	-	-	-	
-	-	-	4,120	5,520	15,000	18,000	26,100	18,000	IR-1012, IRA-10	IRB 1012	
BH-1412	YBH 1412	MH-14121	5,620	9,440	5,880	28,200	49,000	7,000	IR-1012, IRA-10	IRB 1012	
-	-	-	5,710	8,400	15,000	23,600	36,900	18,000	IR-1016	IRB 1016	
BH-1416	-	-	7,570	13,800	5,880	-	-	-	IR-1016	-	
-	-	-	-	-	-	8,000	11,400	16,000	-	-	
B-158	-	-	3,580	6,180	4,500	-	-	-	-	-	
-	-	-	-	-	-	11,000	17,100	16,000	-	IRB 1110	
-	-	-	-	-	-	18,900	34,300	16,000	-	IRB 1116	
B-1516	-	M-15161	7,370	15,600	4,500	-	-	-	-	-	

(1) JT, JTT는 그리스 주입시 허용회전수이며, 그 외에는 오일주입시 허용회전수입니다.

1.1 Shell Type Needle Roller Bearings

인치계열

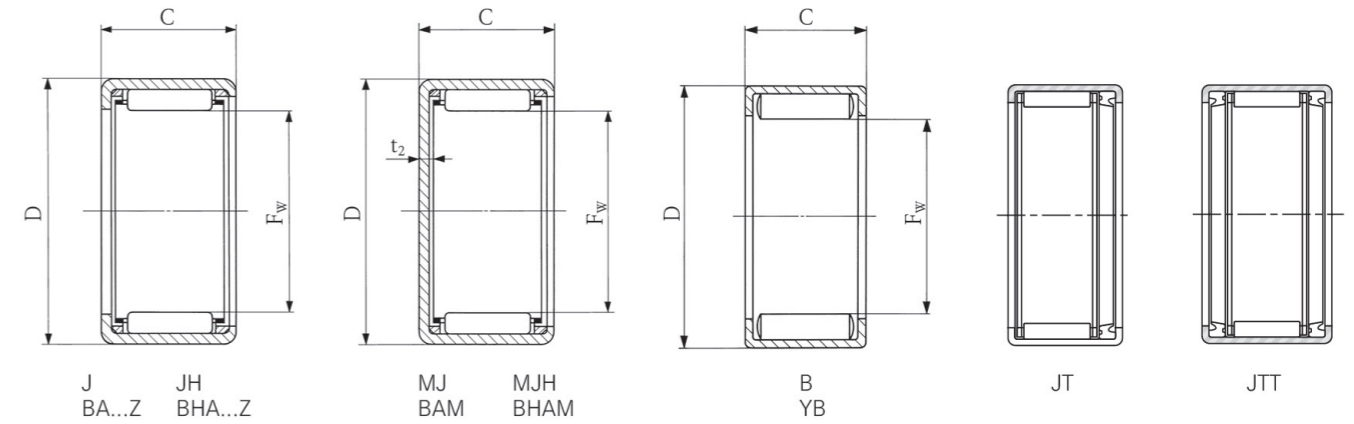

내경 F _w (mm)	외경 D (mm)	폭 C (mm)	유지기형							
			Koyo		IKO		Koyo		IKO	
			개방형1		개방형2		한쪽폐쇄형1		한쪽폐쇄형2	
25.400 (1)	31.750(1 ¼)	9.52(.375)	-	BA 166Z	-	-	-	BAM 166	-	-
	31.750(1 ¼)	9.52(.375)	-	-	-	-	-	-	-	-
	31.750(1 ¼)	11.13(.438)	-	BA 167Z	-	-	-	BAM 167	-	-
	31.750(1 ¼)	11.13(.438)	-	-	-	-	-	-	-	-
	31.750(1 ¼)	12.70(.500)	-	BA 168Z	-	-	-	BAM 168	-	-
	31.750(1 ¼)	12.70(.500)	-	-	-	-	-	-	-	-
	31.750(1 ¼)	15.88(.625)	-	BA 1610Z	-	-	-	BAM 1610	-	-
	31.750(1 ¼)	15.88(.625)	-	-	-	-	-	-	-	-
	31.750(1 ¼)	19.05(.750)	J-1612	BA 1612Z	-	-	-	BAM 1612	-	-
	31.750(1 ¼)	19.05(.750)	-	-	-	-	-	-	-	-
	31.750(1 ¼)	20.62(.812)	JT-1613	-	-	-	-	-	-	-
	31.750(1 ¼)	22.22(.875)	JTT-1614	BA 1614Z	-	-	-	BAM 1614	-	-
	31.750(1 ¼)	25.40(1.000)	J-1616	BA 1616Z	-	-	MJ-16161	BAM 1616	-	-
	31.750(1 ¼)	25.40(1.000)	-	-	-	-	-	-	-	-
	31.750(1 ¼)	31.75(1.250)	-	BA 1620Z	-	-	-	BAM 1620	-	-
	33.338(1 ⅝)	12.70(.500)	-	-	-	BHA 168Z	-	-	-	BHAM 168
	33.338(1 ⅝)	12.70(.500)	-	-	-	-	-	-	-	-
	33.338(1 ⅝)	15.88(.625)	-	-	-	BHA 1610Z	-	-	-	BHAM 1610
	33.338(1 ⅝)	15.88(.625)	-	-	-	-	-	-	-	-
	33.338(1 ⅝)	19.05(.750)	-	-	JH-1612	BHA 1612Z	-	-	MJH-16121	BHAM 1612
	33.338(1 ⅝)	19.05(.750)	-	-	-	-	-	-	-	-
	33.338(1 ⅝)	22.22(.875)	-	-	-	BHA 1614Z	-	-	-	BHAM 1614
	33.338(1 ⅝)	22.22(.875)	-	-	-	-	-	-	-	-
	33.338(1 ⅝)	25.40(1.000)	-	-	JH-1616	BHA 1616Z	-	-	MJH-16161	BHAM 1616
	33.338(1 ⅝)	25.40(1.000)	-	-	-	-	-	-	-	-
	33.338(1 ⅝)	31.75(1.250)	-	-	-	BHA 1620Z	-	-	-	BHAM 1620
	33.338(1 ⅝)	31.75(1.250)	-	-	-	-	-	-	-	-
	33.338(1 ⅝)	38.10(1.500)	-	-	-	BHA 1624Z	-	-	-	BHAM 1624
	33.338(1 ⅝)	38.10(1.500)	-	-	-	-	-	-	-	-

총롤러형			사양						적합한 Inner Ring		
Koyo	IKO	Koyo	Koyo		IKO	허용 회전수	동정격하중	정적격하중	허용 회전수	Koyo	IKO
개방형	한쪽폐쇄형	한쪽폐쇄형	동정격하중 C lbf	정적격하중 C ₀ lbf	허용 회전수 rpm ⁽¹⁾	동정격하중 C N	정적격하중 C ₀ N	허용 회전수 rpm ⁽¹⁾			
-	-	-	-	-	-	6,010	8,020	15,000	-	-	
B-166	-	-	2,550	4,070	4,300	-	-	-	-	-	
-	-	-	-	-	-	7,720	11,100	15,000	-	-	
B-167	-	M-1671	3,140	5,320	4,300	-	-	-	-	-	
-	-	-	-	-	-	8,240	12,000	15,000	-	IRB 128	
B-168	YB 168	M-1681	3,710	6,590	4,300	19,400	36,000	6,000	IR-128	IRB 128	
-	-	-	-	-	-	11,300	18,100	15,000	-	-	
B-1610	-	M-16101	4,770	9,110	4,300	-	-	-	-	-	
-	-	-	4,080	6,480	13,000	14,200	24,300	15,000	IR-1212, IR-1312	IRB 1212	
B-1612	YB 1612	M-16121	5,770	11,600	4,300	28,200	58,000	6,000	IR-1212, IR-1312	IRB 1212	
-	-	-	4,080	6,480	7,600	-	-	-	-	-	
-	-	-	4,080	6,480	7,600	16,900	30,400	15,000	-	IRB 1214	
-	-	-	5,610	9,760	13,000	19,400	36,300	15,000	IR-1216, IR-1312	IRB 1216	
B-1616	YB 1616	M-16161	7,630	16,700	4,300	36,300	80,300	6,000	IR-1216, IR-1312	IRB 1216	
-	-	-	-	-	-	24,400	48,500	15,000	-	IRB 1220	
-	-	-	-	-	-	10,200	13,100	15,000	-	IRB 128	
BH-168	YBH 168	MH-1681	3,740	5,760	5,200	20,900	34,100	6,000	-	IRB 128	
-	-	-	-	-	-	15,300	22,100	15,000	-	-	
BH-1610	-	-	4,950	8,280	5,200	-	-	-	-	-	
-	-	-	4,650	6,650	13,000	19,300	29,700	15,000	-	IRB 1212	
BH-1612	YBH 1612	MH-16121	6,090	10,800	5,200	30,700	56,100	6,000	-	IRB 1212	
-	-	-	-	-	-	23,000	37,200	15,000	-	IRB 1214	
BH-1614	-	-	7,170	13,300	5,200	-	-	-	-	-	
-	-	-	6,200	9,640	13,000	26,400	44,500	15,000	IR-1216, IR-1312	IRB 1216	
BH-1616	YBH 1616	MH-16161	8,200	15,800	5,200	39,900	78,400	6,000	IR-1216, IR-1312	IRB 1216	
-	-	-	-	-	-	33,200	59,600	15,000	-	IRB 1220	
BH-1620	-	-	10,200	20,900	5,200	-	-	-	IR-1220, IR-1224	-	
-	-	-	-	-	-	39,400	74,400	15,000	-	-	
BH-1624	-	MH-16241	12,000	25,900	5,200	-	-	-	-	-	

(1) JT, JTT는 그리스 주입시 허용회전수이며, 그 외에는 오일주입시 허용회전수입니다.

1.1 Shell Type Needle Roller Bearings

인치계열

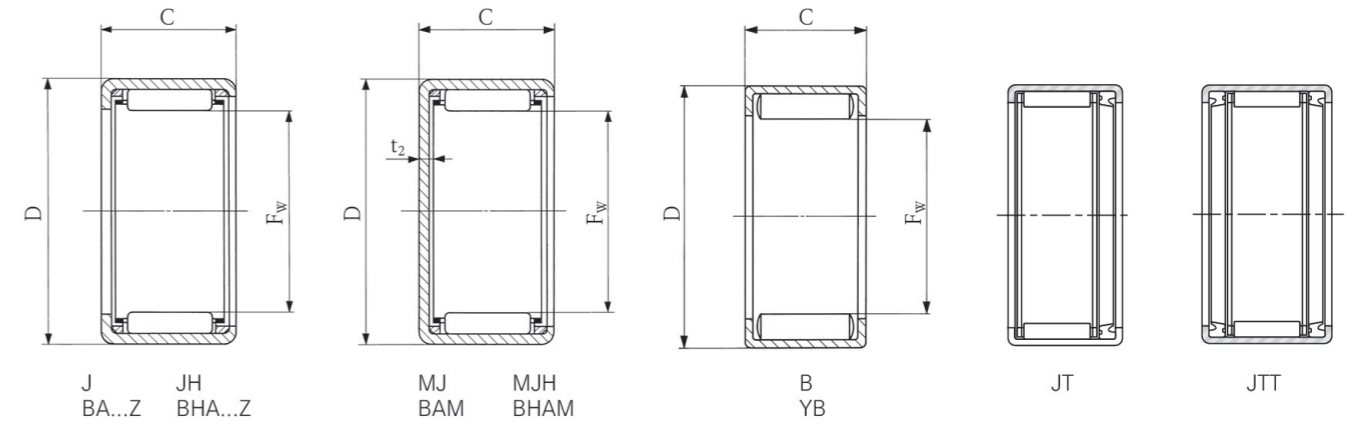

내경 F _w (mm)	외경 D (mm)	폭 C (mm)	유지기형									
			Koyo		IKO		Koyo		IKO			
			개방형1		개방형2		한쪽폐쇄형1		한쪽폐쇄형2			
26.988 (1 1/16)	33.338(1 1/8)	15.88(.625)	-	BA 1710Z	-	-	-	-	BAM 1710	-	-	
	33.338(1 1/8)	15.88(.625)	-	-	-	-	-	-	-	-	-	
	33.338(1 1/8)	25.40(1.000)	-	BA 1716Z	-	-	-	-	BAM 1716	-	-	
28.575 (1 1/8)	34.925(1 3/8)	9.52(.375)	-	BA 186Z	-	-	-	-	BAM 186	-	-	
	34.925(1 3/8)	9.52(.375)	-	-	-	-	-	-	-	-	-	
	34.925(1 3/8)	12.70(.500)	J-188	BA 188Z	-	-	MJ-1881	BAM 188	-	-	-	
	34.925(1 3/8)	12.70(.500)	-	-	-	-	-	-	-	-	-	
	34.925(1 3/8)	15.88(.625)	-	-	-	-	-	-	-	-	-	
	34.925(1 3/8)	19.05(.750)	J-1812	BA 1812Z	-	-	MJ-18121	BAM 1812	-	-	-	
	34.925(1 3/8)	19.05(.750)	-	-	-	-	-	-	-	-	-	
	34.925(1 3/8)	20.62(.812)	JT-1813	-	-	-	-	-	-	-	-	
	34.925(1 3/8)	22.22(.875)	JTT-1814	-	-	-	-	-	-	-	-	
	34.925(1 3/8)	25.40(1.000)	J-1816	BA 1816Z	-	-	MJ-18161	BAM 1816	-	-	-	
	34.925(1 3/8)	25.40(1.000)	-	-	-	-	-	-	-	-	-	
	34.925(1 3/8)	31.75(1.250)	-	BA 1820Z	-	-	-	BAM 1820	-	-	-	
	38.100(1 1/2)	19.05(.750)	-	-	JH-1812	BHA 1812Z	-	-	MJH-18121	BHAM 1812	-	-
	38.100(1 1/2)	19.05(.750)	-	-	-	-	-	-	-	-	-	
	38.100(1 1/2)	25.40(1.000)	-	-	JH-1816	BHA 1816Z	-	-	MJH-18161	BHAM 1816	-	-
	38.100(1 1/2)	25.40(1.000)	-	-	-	-	-	-	-	-	-	
	38.100(1 1/2)	28.58(1.125)	-	-	JH-1818	BHA 1818Z	-	-	MJH-18181	BHAM 1818	-	-
	38.100(1 1/2)	31.75(1.250)	-	-	-	BHA 1820Z	-	-	-	BHAM 1820	-	-
38.100(1 1/2)	31.75(1.250)	-	-	-	-	-	-	-	-	-		
30.162 (1 1/8)	38.100(1 1/2)	15.88(.625)	-	BA 1910Z	-	-	-	BAM 1910	-	-	-	
	38.100(1 1/2)	15.88(.625)	-	-	-	-	-	-	-	-	-	
	38.100(1 1/2)	25.40(1.000)	-	BA 1916Z	-	-	-	BAM 1916	-	-	-	
	38.100(1 1/2)	25.40(1.000)	-	-	-	-	-	-	-	-	-	

총roller형			사양						적합한 Inner Ring	
Koyo	IKO	Koyo	Koyo		IKO	IKO		Koyo	IKO	
개방형	한쪽폐쇄형	한쪽폐쇄형	동정격하중 C lbf	정적격하중 C ₀ lbf	허용 회전수 rpm ⁽¹⁾	동정격하중 C N	정적격하중 C ₀ N	허용 회전수 rpm ⁽¹⁾		
-	-	-	-	-	-	11,600	19,200	14,000	-	-
B-1710	-	M-17101	4,930	9,680	4,000	-	-	-	-	-
-	-	-	-	-	-	20,000	38,300	14,000	-	-
-	-	-	-	-	-	6,330	8,910	13,000	-	-
B-186	-	M-1861	2,720	4,580	3,800	-	-	-	-	-
-	-	-	2,620	3,810	11,000	8,680	13,400	13,000	-	IRB 148
B-188	YB 188	M-1881	3,950	7,420	3,800	20,700	40,500	5,500	-	IRB 148
B-1810	-	-	5,080	10,300	3,800	-	-	-	-	-
-	-	-	4,280	7,140	11,000	15,000	26,900	13,000	-	IRB 1412
B-1812	YB 1812	M-18121	6,140	13,100	3,800	30,000	65,300	5,500	-	IRB 1412
-	-	-	4,280	7,140	6,800	-	-	-	-	-
-	-	-	4,280	7,140	6,800	-	-	-	-	-
-	-	-	5,880	10,800	11,000	20,500	40,300	13,000	IR-1416, IRA-14	IRB 1416
B-1816	YB 1816	M-18161	8,130	18,800	3,800	38,700	90,400	5,500	IR-1416, IRA-14	IRB 1416
-	-	-	-	-	-	25,700	53,900	13,000	-	IRB 1420
-	-	-	5,250	7,140	12,000	22,500	32,200	13,000	-	IRB 1412
BH-1812	-	MH-18121	7,090	11,900	5,600	-	-	-	-	-
-	-	-	7,450	11,100	12,000	30,900	48,600	13,000	IR-1416, IRA-14	IRB 1416
BH-1816	-	MH-18161	9,560	17,500	5,600	-	-	-	IR-1416, IRA-14	-
-	-	-	8,160	12,500	12,000	34,900	56,600	13,000	-	-
-	-	-	-	-	-	37,100	61,100	13,000	-	IRB 1420
BH-1820	-	MH-18201	11,900	23,200	5,600	-	-	-	-	-
-	-	-	-	-	-	15,000	22,500	12,000	-	-
B-1910	YB 1910	M-19101	5,420	9,840	4,400	28,400	53,600	5,000	-	-
-	-	-	-	-	-	25,800	45,300	12,000	-	-
B-1916	-	-	8,980	18,800	4,400	-	-	-	-	-

(1) JT, JTT는 그리스 주입시 허용회전수이며, 그 외에는 오일주입시 허용회전수입니다.

1.1 Shell Type Needle Roller Bearings

인치계열

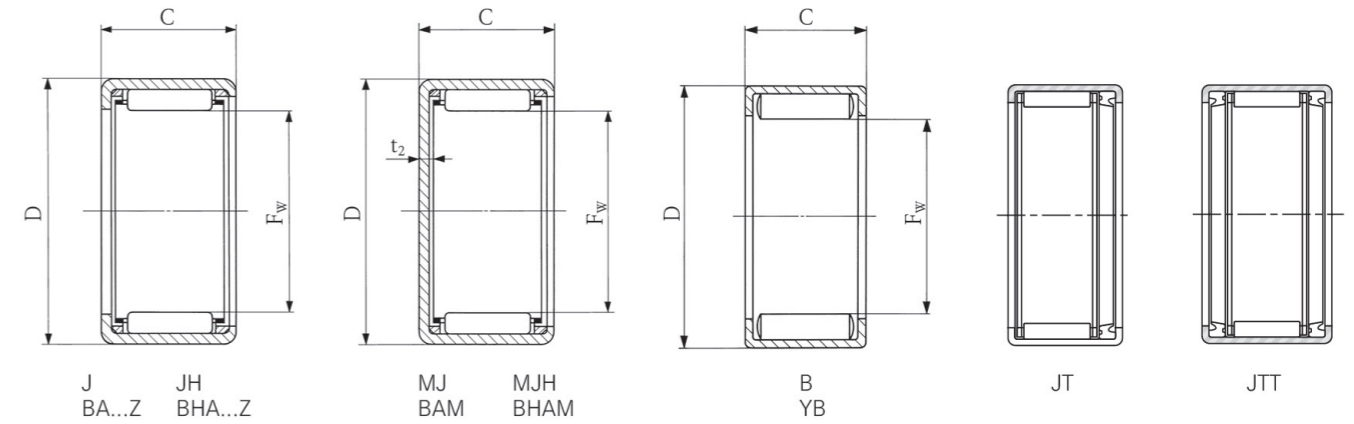

내경 F _w (mm)	외경 D (mm)	폭 C (mm)	유지기형									
			Koyo		IKO		Koyo		IKO			
			개방형1		개방형2		한쪽폐쇄형1		한쪽폐쇄형2			
31.750 (1 1/4)	38.100(1 1/2)	12.70(.500)	-	BA 208Z	-	-	-	-	BAM 208	-	-	
	38.100(1 1/2)	12.70(.500)	-	-	-	-	-	-	-	-	-	
	38.100(1 1/2)	15.88(.625)	-	BA 2010Z	-	-	-	-	BAM 2010	-	-	
	38.100(1 1/2)	15.88(.625)	-	-	-	-	-	-	-	-	-	
	38.100(1 1/2)	19.05(.750)	J-2012	BA 2012Z	-	-	-	-	-	-	-	
	38.100(1 1/2)	19.05(.750)	-	-	-	-	-	-	-	-	-	
	38.100(1 1/2)	20.62(.812)	JT-2013	-	-	-	-	-	-	-	-	
	38.100(1 1/2)	25.40(1.000)	J-2016	BA 2016Z	-	-	-	-	MJ-20161	BAM 2016	-	-
	38.100(1 1/2)	25.40(1.000)	-	-	-	-	-	-	-	-	-	
	38.100(1 1/2)	28.58(1.125)	JTT-2018	-	-	-	-	-	-	-	-	
	38.100(1 1/2)	31.75(1.250)	-	BA 2020Z	-	-	-	-	-	BAM 2020	-	-
	38.100(1 1/2)	31.75(1.250)	-	-	-	-	-	-	-	-	-	
	41.275(1 5/8)	12.70(.500)	-	-	-	BHA 208Z	-	-	-	-	BHAM 208	
	41.275(1 5/8)	12.70(.500)	-	-	-	-	-	-	-	-	-	
	41.275(1 5/8)	19.05(.750)	-	-	JH-2012	BHA 2012Z	-	-	-	-	BHAM 2012	
	41.275(1 5/8)	19.05(.750)	-	-	-	-	-	-	-	-	-	
41.275(1 5/8)	25.40(1.000)	-	-	JH-2016	BHA 2016Z	-	-	-	-	BHAM 2016		
41.275(1 5/8)	25.40(1.000)	-	-	-	-	-	-	-	-	-		
41.275(1 5/8)	31.75(1.250)	-	-	JH-2020	BHA 2020Z	-	-	-	-	BHAM 2020		
41.275(1 5/8)	31.75(1.250)	-	-	-	-	-	-	-	-	-		
33.338 (1 1/8)	41.275(1 5/8)	12.70(.500)	-	BA 218Z	-	-	-	-	BAM 218	-	-	
	41.275(1 5/8)	12.70(.500)	-	-	-	-	-	-	-	-	-	
	41.275(1 5/8)	15.88(.625)	-	BA 2110Z	-	-	-	-	BAM 2110	-	-	
	41.275(1 5/8)	15.88(.625)	-	-	-	-	-	-	-	-	-	
	41.275(1 5/8)	19.05(.750)	-	BA 2112Z	-	-	-	-	BAM 2112	-	-	

총roller형			사양						적합한 Inner Ring	
Koyo	IKO	Koyo	Koyo		IKO	IKO		Koyo	IKO	
개방형	한쪽폐쇄형	한쪽폐쇄형	동정격하중 C lbf	정적격하중 C ₀ lbf	허용 회전수 rpm ⁽¹⁾	동정격하중 C N	정적격하중 C ₀ N	허용 회전수 rpm ⁽¹⁾		
-	-	-	-	-	-	9,100	14,700	12,000	-	IRB 168
B-208	-	M-2081	4,170	8,240	3,500	-	-	-	-	-
-	-	-	-	-	-	12,500	22,200	12,000	-	IRB 1610
B-2010	YB 2010	M-20101	5,370	11,400	3,500	27,000	59,000	4,500	-	IRB 1610
-	-	-	4,460	7,800	10,000	15,700	29,600	12,000	IR-1612	IRB 1612
B-2012	YB 2012	M-20121	6,490	14,500	3,500	31,800	72,500	4,500	IR-1612	IRB 1612
-	-	-	4,460	7,800	6,100	-	-	-	-	-
-	-	-	6,480	12,700	10,000	21,500	44,300	12,000	IR-1616,IRA-16	IRB 1616
B-2016	YB 2016	M-20161	8,590	20,800	3,500	40,900	100,000	4,500	IR-1616,IRA-16	IRB 1616
-	YB 2018	-	6,480	12,700	6,100	45,300	114,000	4,500	-	-
-	-	-	-	-	-	26,900	59,200	12,000	-	IRB 1620
B-2020	YB 2020	M-20201	10,600	27,200	3,500	49,400	128,000	4,500	-	IRB 1620
-	-	-	-	-	-	13,700	17,600	12,000	-	IRB 168
BH-208	-	MH-2081	4,420	6,750	5,000	-	-	-	-	-
-	-	-	5,420	7,630	10,000	24,100	36,400	12,000	-	IRB 1612
BH-2012	-	MH-20121	7,440	13,200	5,000	-	-	-	-	-
-	-	-	7,630	11,900	10,000	33,200	55,000	12,000	-	IRB 1616
BH-2016	-	MH-20161	10,100	19,500	5,000	-	-	-	-	-
-	-	-	9,750	16,300	10,000	40,000	69,600	12,000	-	IRB 1620
BH-2020	-	MH-20201	12,600	25,800	5,000	-	-	-	-	-
-	-	-	-	-	-	11,100	15,800	11,000	-	IRB 168-1
B-218	-	M-2181	4,330	7,570	4,100	-	-	-	-	-
-	-	-	-	-	-	15,400	23,900	11,000	-	IRB 1610-1
B-2110	-	M-21101	5,740	10,900	4,100	-	-	-	-	-
-	-	-	-	-	-	19,300	32,100	11,000	-	IRB 1612-1
B-2120	-	-	11,800	27,500	4,100	-	-	-	-	-

(1) JT, JTT는 그리스 주입시 허용회전수이며, 그 외에는 오일주입시 허용회전수입니다.

1.1 Shell Type Needle Roller Bearings

인치계열

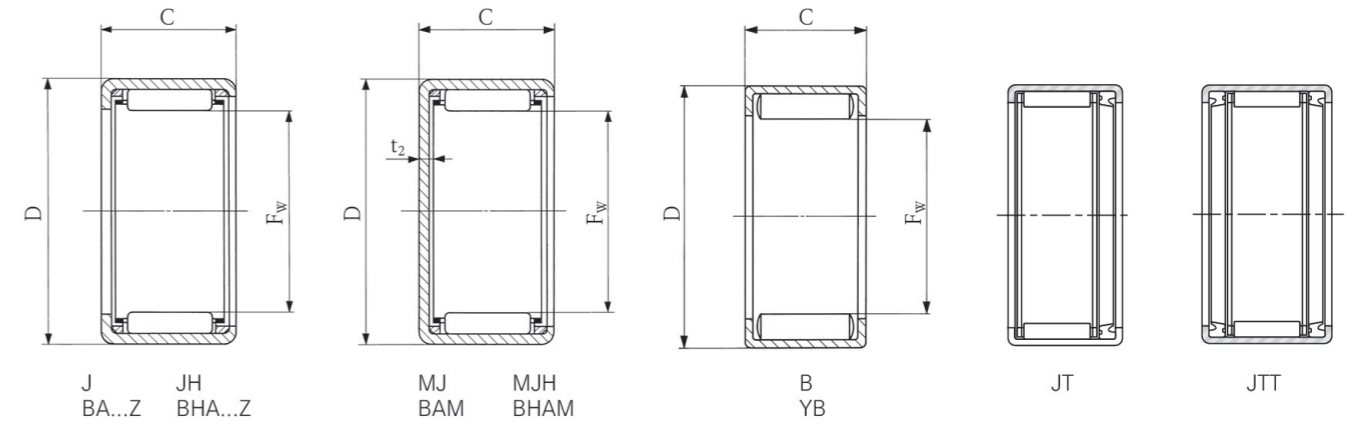

내경 F _w (mm)	외경 D (mm)	폭 C (mm)	유지기형							
			Koyo		IKO		Koyo		IKO	
			개방형1		개방형2		한쪽폐쇄형1		한쪽폐쇄형2	
34.925 (1 3/8)	41.275 (1 5/8)	12.70 (.500)	J-228	BA 228Z	-	-	MJ-2281	BAM 228	-	-
	41.275 (1 5/8)	12.70 (.500)	-	-	-	-	-	-	-	-
	41.275 (1 5/8)	19.05 (.750)	J-2212	BA 2212Z	-	-	-	BAM 2212	-	-
	41.275 (1 5/8)	19.05 (.750)	-	-	-	-	-	-	-	-
	41.275 (1 5/8)	25.40 (1.000)	-	BA 2216Z	-	-	-	BAM 2216	-	-
	41.275 (1 5/8)	31.75 (1.250)	-	BA 2220Z	-	-	-	BAM 2220	-	-
	41.275 (1 5/8)	31.75 (1.250)	-	-	-	-	-	-	-	-
	44.450 (1 3/4)	12.70 (.500)	-	-	-	BHA 228Z	-	-	-	BHAM 228
	44.450 (1 3/4)	15.88 (.625)	-	-	-	BHA 2210Z	-	-	-	BHAM 2210
	44.450 (1 3/4)	19.05 (.750)	-	-	JH-2212	BHA 2212Z	-	-	MJH-22121	BHAM 2212
	44.450 (1 3/4)	19.05 (.750)	-	-	-	-	-	-	-	-
	44.450 (1 3/4)	25.40 (1.000)	-	-	JH-2216	BHA 2216Z	-	-	MJH-22161	BHAM 2216
	44.450 (1 3/4)	25.40 (1.000)	-	-	-	-	-	-	-	-
	44.450 (1 3/4)	31.75 (1.250)	-	-	-	BHA 2220Z	-	-	-	BHAM 2220
38.100 (1 1/2)	47.625 (1 7/8)	9.52 (.375)	-	-	-	-	-	-	-	-
	47.625 (1 7/8)	12.70 (.500)	-	BA 248Z	-	-	-	BAM 248	-	-
	47.625 (1 7/8)	12.70 (.500)	-	-	-	-	-	-	-	-
	47.625 (1 7/8)	15.88 (.625)	-	BA 2410Z	-	-	-	BAM 2410	-	-
	47.625 (1 7/8)	15.88 (.625)	-	-	-	-	-	-	-	-
	47.625 (1 7/8)	19.05 (.750)	J-2412	BA 2412Z	-	-	MJ-24121	BAM 2412	-	-
	47.625 (1 7/8)	19.05 (.750)	-	-	-	-	-	-	-	-
	47.625 (1 7/8)	22.22 (.875)	-	BA 2414Z	-	-	-	BAM 2414	-	-
	47.625 (1 7/8)	22.22 (.875)	-	-	-	-	-	-	-	-
	47.625 (1 7/8)	25.40 (1.000)	J-2416	BA 2416Z	-	-	MJ-24161	BAM 2416	-	-
	47.625 (1 7/8)	25.40 (1.000)	-	-	-	-	-	-	-	-
	47.625 (1 7/8)	31.75 (1.250)	J-2420	BA 2420Z	-	-	-	BAM 2420	-	-
	47.625 (1 7/8)	31.75 (1.250)	-	-	-	-	-	-	-	-
	47.625 (1 7/8)	33.32 (1.312)	JT-2421	-	-	-	-	-	-	-

총롤러형			사양						적합한 Inner Ring		
Koyo	IKO	Koyo	Koyo		IKO	허용 회전수	동정격하중	정적격하중	허용 회전수	Koyo	IKO
개방형	한쪽폐쇄형	한쪽폐쇄형	동정격하중 C lbf	정적격하중 C ₀ lbf	허용 회전수 rpm ⁽¹⁾	동정격하중 C N	정적격하중 C ₀ N	허용 회전수 rpm ⁽¹⁾			
-	-	-	3,140	5,150	9,200	9,770	16,600	10,000	-	IRB 188	
B-228	YB 228	M-2281	4,390	9,070	3,200	23,000	49,500	4,500	-	IRB 188	
-	-	-	5,130	9,660	9,200	16,900	33,500	10,000	IR-1812	IRB 1812	
B-2212	YB 2212	M-22121	6,830	16,000	3,200	33,400	79,800	4,500	IR-1812	IRB 1812	
B-2216	-	M-22161	9,030	22,900	3,200	23,100	50,200	10,000	IR-1816	IRB 1816	
-	-	-	-	-	-	28,900	67,100	10,000	-	IRB 1820	
B-2220	YB 2220	M-22201	11,100	29,900	3,200	52,000	141,000	4,500	IR-1820	IRB 1820	
BH-228	-	-	4,770	7,540	4,700	14,100	18,800	10,000	-	IRB 188	
BH-2210	-	-	6,410	11,000	4,700	19,700	28,800	10,000	-	-	
-	-	-	5,900	8,640	9,400	24,800	38,800	10,000	IR-1812	IRB 1812	
BH-2212	-	MH-22121	7,930	14,500	4,700	-	-	-	IR-1812	-	
-	-	-	8,210	13,200	9,400	34,100	58,400	10,000	IR-1816	IRB 1816	
BH-2216	-	MH-22161	10,700	21,300	4,700	-	-	-	IR-1816	-	
BH-2220	-	-	13,400	28,300	4,700	41,200	74,200	10,000	IR-1820	IRB 1820	
-	YB 246	-	-	-	-	21,000	34,100	4,000	-	-	
-	-	-	-	-	-	12,900	17,900	9,000	-	-	
B-248	YB 248	M-2481	5,020	8,340	4,300	28,700	50,900	4,000	-	-	
-	-	-	-	-	-	17,800	27,100	9,000	-	IRB 2010	
B-2410	-	M-24101	6,710	12,100	4,300	-	-	-	-	-	
-	-	-	6,720	10,600	8,600	22,500	36,600	9,000	-	-	
B-2412	-	M-24121	8,290	15,900	4,300	-	-	-	-	-	
-	-	-	-	-	-	26,700	45,600	9,000	-	IRB 2014	
B-2414	YB 2414	M-24141	9,780	19,700	4,300	48,900	101,000	4,000	-	IRB 2014	
-	-	-	8,840	15,000	8,600	31,100	55,400	9,000	IR-1916, IR-2016	IRB 2016	
B-2416	YB 2416	M-24161	11,200	23,300	4,300	55,100	118,000	4,000	IR-1916, IR-2016	IRB 2016	
-	-	-	11,100	20,200	8,600	39,000	74,200	9,000	IR-1920, IR-2020	IRB 2020	
B-2420	YB 2420	M-24201	13,900	31,000	4,300	66,800	151,000	4,000	IR-1920, IR-2020	IRB 2020	
-	-	-	11,100	20,200	5,100	-	-	-	-	-	

(1) JT, JTT는 그리스 주입시 허용회전수이며, 그 외에는 오일주입시 허용회전수입니다.

1.1 Shell Type Needle Roller Bearings

인치계열

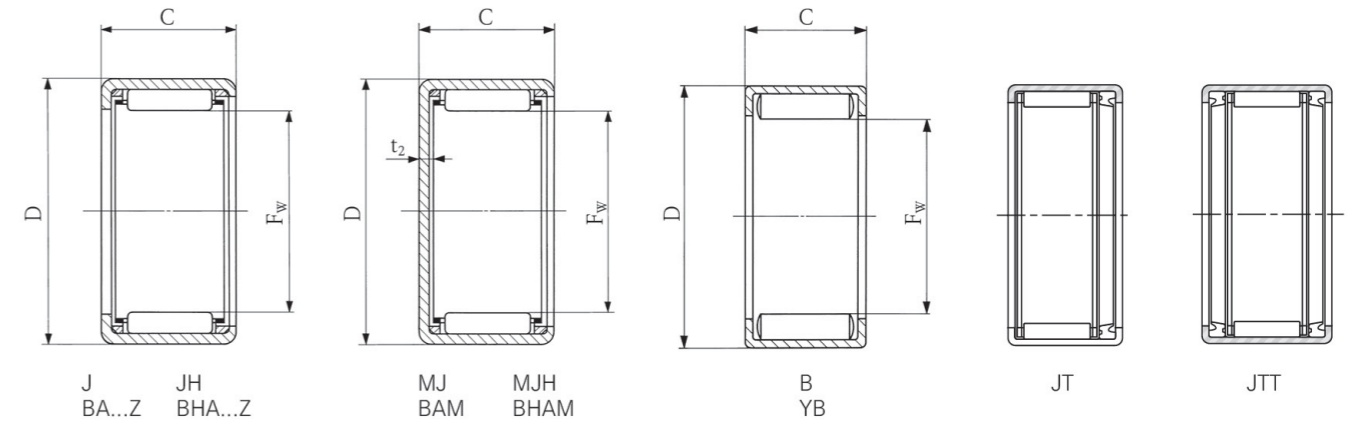
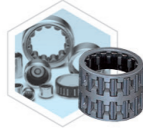

내경 F _w (mm)	외경 D (mm)	폭 C (mm)	유지기형							
			Koyo		IKO		Koyo		IKO	
			개방형1		개방형2		한쪽폐쇄형1		한쪽폐쇄형2	
41.275 (1 1/8)	50.800(2)	12.70(.500)	-	BA 268Z	-	-	-	BAM 268	-	-
	50.800(2)	12.70(.500)	-	-	-	-	-	-	-	-
	50.800(2)	15.88(.625)	J-2610	BA 2610Z	-	-	-	BAM 2610	-	-
	50.800(2)	15.88(.625)	-	-	-	-	-	-	-	-
	50.800(2)	25.40(1.000)	J-2616	BA 2616Z	-	-	MJ-26161	BAM 2616	-	-
	50.800(2)	25.40(1.000)	-	-	-	-	-	-	-	-
	50.800(2)	31.75(1.250)	-	BA 2620Z	-	-	-	BAM 2620	-	-
	50.800(2)	31.75(1.250)	-	-	-	-	-	-	-	-
44.450 (1 3/8)	53.975(2 1/8)	19.50(.750)	J-2812	BA 2812Z	-	-	MJ-28121	BAM 2812	-	-
	53.975(2 1/8)	19.50(.750)	-	-	-	-	-	-	-	-
	53.975(2 1/8)	25.40(1.000)	J-2816	BA 2816Z	-	-	MJ-28161	BAM 2816	-	-
	53.975(2 1/8)	25.40(1.000)	-	-	-	-	-	-	-	-
	53.975(2 1/8)	31.75(1.250)	-	BA 2820Z	-	-	-	BAM 2820	-	-
	53.975(2 1/8)	31.75(1.250)	-	-	-	-	-	-	-	-
	53.975(2 1/8)	38.10(1.500)	J-2824	BA 2824Z	-	-	MJ-28241	BAM 2824	-	-
	53.975(2 1/8)	38.10(1.500)	-	-	-	-	-	-	-	-
47.625 (1 7/8)	57.150(2 1/4)	38.10(1.500)	-	-	-	BHA 2824Z	-	-	-	BHAM 2824
	57.150(2 1/4)	12.70(.500)	-	BA 308Z	-	-	-	BAM 308	-	-
	57.150(2 1/4)	12.70(.500)	-	-	-	-	-	-	-	-
	57.150(2 1/4)	15.88(.625)	-	BA 3010Z	-	-	-	BAM 3010	-	-
	57.150(2 1/4)	19.05(.750)	-	BA 3012Z	-	-	-	BAM 3012	-	-
	57.150(2 1/4)	19.05(.750)	-	-	-	-	-	-	-	-
	57.150(2 1/4)	25.40(1.000)	J-3016	BA 3016Z	-	-	MJ-30161	BAM 3016	-	-
	57.150(2 1/4)	25.40(1.000)	-	-	-	-	-	-	-	-

총roller형			사양						적합한 Inner Ring	
Koyo	IKO	Koyo	Koyo			IKO			Koyo	IKO
개방형	한쪽폐쇄형	한쪽폐쇄형	동정격하중	정적격하중	허용 회전수	동정격하중	정적격하중	허용 회전수		
			C lbf	C ₀ lbf	rpm ⁽¹⁾	C N	C ₀ N	rpm ⁽¹⁾		
-	-	-	-	-	-	13,700	19,800	8,000	-	-
B-268	-	-	5,120	8,820	3,900	-	-	-	-	-
-	-	-	5,870	9,210	7,900	18,900	30,000	8,000	-	IRB 2210
B-2610	YB 2610	M-26101	6,890	12,900	3,900	37,000	71,700	3,500	-	IRB 2210
-	-	-	8,830	15,500	7,900	33,000	61,400	8,000	-	-
B-2616	-	-	11,600	25,200	3,900	-	-	-	-	-
-	-	-	-	-	-	41,400	82,100	8,000	-	IRB 2220
B-2620	-	M-26201	14,400	33,400	3,900	-	-	-	IR-2220	-
-	-	-	6,650	11,100	7,300	25,200	44,500	7,500	-	IRB 2412
B-2812	-	M-28121	8,830	18,300	3,700	-	-	-	-	-
-	-	-	9,010	16,400	7,300	34,800	67,400	7,500	IR-2316, IR-2416	IRB 2416
B-2816	YB 2816	M-28161	12,000	27,100	3,700	59,500	136,000	3,500	IR-2316, IR-2416	IRB 2416
-	-	-	-	-	-	43,600	90,200	7,500	-	-
B-2820	-	-	14,900	36,000	3,700	-	-	-	-	-
-	-	-	13,400	27,400	7,300	52,000	113,000	7,500	IR-2324, IR-2424	IRB 2424
B-2824	-	M-28241	17,700	44,800	3,700	-	-	-	IR-2324, IR-2424	-
-	-	-	-	-	-	72,200	135,000	7,500	-	IRB 2424
-	-	-	-	-	-	14,700	22,800	7,000	-	IRB 248-1
B-308	-	M-3081	5,650	10,400	3,500	-	-	-	-	-
-	-	-	-	-	-	20,300	34,500	7,000	-	IRB 2410-1
-	-	-	-	-	-	25,700	46,700	7,000	-	-
B-3012	YB 3012	-	9,330	19,900	3,500	47,800	105,000	3,000	-	-
-	-	-	9,240	17,100	6,800	35,400	70,600	7,000	-	-
B-3016	-	M-30161	12,600	29,200	3,500	-	-	-	-	-

(1) JT, JTT는 그리스 주입시 허용회전수이며, 그 외에는 오일주입시 허용회전수입니다.

1.1 Shell Type Needle Roller Bearings

인치계열

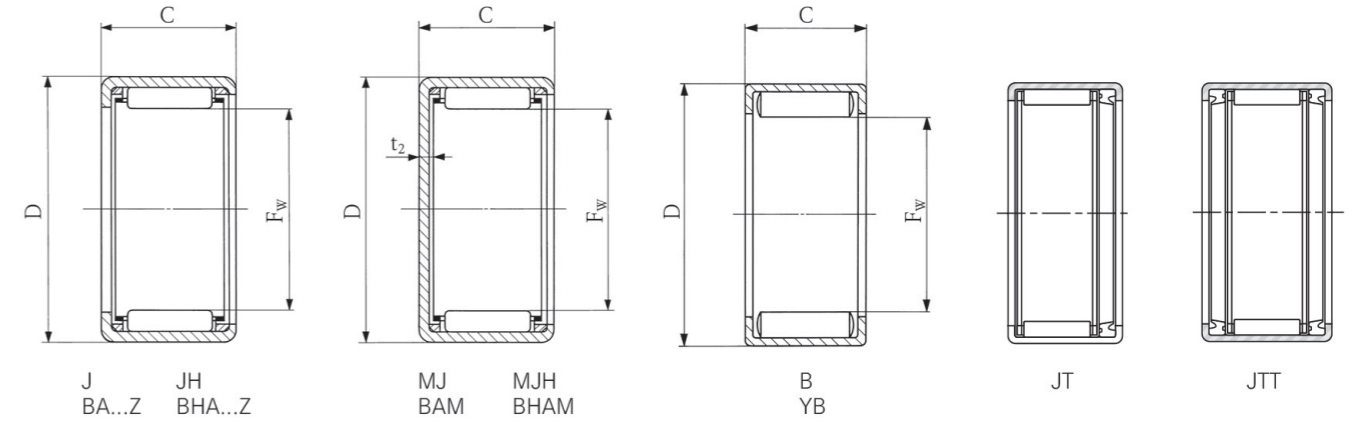

내경 F _w (mm)	외경 D (mm)	폭 C (mm)	유지기형							
			Koyo	IKO	Koyo	IKO	Koyo	IKO	Koyo	IKO
			개방형1		개방형2		한쪽폐쇄형1		한쪽폐쇄형2	
50.800 (2)	60.325 (2 3/8)	12.70 (.500)	-	BA 328Z	-	-	-	BAM 328	-	-
	60.325 (2 3/8)	12.70 (.500)	-	-	-	-	-	-	-	-
	60.325 (2 3/8)	25.40 (1.000)	J-3216	BA 3216Z	-	-	MJ-32161	BAM 3216	-	-
	60.325 (2 3/8)	25.40 (1.000)	-	-	-	-	-	-	-	-
	60.325 (2 3/8)	31.75 (1.250)	-	BA 3220Z	-	-	-	BAM 3220	-	-
	60.325 (2 3/8)	31.75 (1.250)	-	-	-	-	-	-	-	-
	60.325 (2 3/8)	38.10 (1.500)	-	BA 3224Z	-	-	-	BAM 3224	-	-
	60.325 (2 3/8)	38.10 (1.500)	-	-	-	-	-	-	-	-
	60.325 (2 3/8)	44.45 (1.750)	-	BAW 3228Z	-	-	-	BAMW 3228	-	-
52.388 (2 1/8)	64.294 (2 1/2)	19.05 (.750)	-	-	-	BHA 3312Z	-	-	-	BHAM 3312
	64.294 (2 1/2)	25.40 (1.000)	-	-	-	BHA 3316Z	-	-	-	BHAM 3316
	64.294 (2 1/2)	38.10 (1.500)	-	-	-	BHA 3324Z	-	-	-	BHAM 3324
53.975 (2 1/4)	63.500 (2 1/2)	12.70 (.500)	-	BA 348Z	-	-	-	BAM 348	-	-
	63.500 (2 1/2)	25.40 (1.000)	-	BA 3416Z	-	-	-	BAM 3416	-	-
	63.500 (2 1/2)	31.75 (1.250)	-	-	-	-	-	-	-	-
	63.500 (2 1/2)	38.10 (1.500)	-	BA 3424Z	-	-	-	BAM 3424	-	-
57.150 (2 1/4)	66.675 (2 5/8)	19.05 (.750)	J-3612	BA 3612Z	-	-	-	BAM 3612	-	-
	66.675 (2 5/8)	19.05 (.750)	-	-	-	-	-	-	-	-
	66.675 (2 5/8)	25.40 (1.000)	J-3616	BA 3616Z	-	-	-	BAM 3616	-	-
	66.675 (2 5/8)	31.75 (1.250)	-	BA 3620Z	-	-	-	BAM 3620	-	-
	66.675 (2 5/8)	38.10 (1.500)	-	BA 3624Z	-	-	-	BAM 3624	-	-
66.675 (2 5/8)	76.200 (3)	25.40 (1.000)	-	BA 4216Z	-	-	-	BAM 4216	-	-
69.850 (2 3/4)	79.375 (3 1/8)	15.88 (.625)	-	BA 4410Z	-	-	-	BAM 4410	-	-
	79.375 (3 1/8)	19.05 (.750)	J-4412	BA 4412Z	-	-	-	BAM 4412	-	-
	79.375 (3 1/8)	25.40 (1.000)	-	BA 4416Z	-	-	-	BAM 4416	-	-
	79.375 (3 1/8)	31.75 (1.250)	-	BA 4420Z	-	-	-	BAM 4420	-	-
88.900 (3 1/2)	101.600 (4)	19.05 (.750)	-	-	-	-	-	-	-	
139.700 (5 1/2)	152.400 (6)	19.05 (.750)	-	-	-	-	-	-	-	

총롤러형			사양						적합한 Inner Ring	
Koyo	IKO	Koyo	Koyo			IKO			Koyo	IKO
개방형	한쪽폐쇄형	한쪽폐쇄형	동정격하중 C lbf	정적격하중 C ₀ lbf	허용 회전수 rpm ⁽¹⁾	동정격하중 C N	정적격하중 C ₀ N	허용 회전수 rpm ⁽¹⁾		
-	-	-	-	-	-	15,400	24,700	6,000	-	-
B-328	-	M-3281	5,710	10,800	3,300	-	-	-	-	-
-	-	-	9,530	18,300	6,300	37,100	76,500	6,000	-	IRB 2616
B-3216	YB 3216	M-32161	12,900	31,000	3,300	64,100	156,000	2,500	-	IRB 2616
-	-	-	-	-	-	46,600	102,000	6,000	-	IRB 2720
B-3220	-	M-32201	16,100	41,100	3,300	-	-	-	-	-
-	-	-	-	-	-	55,500	128,000	6,000	-	-
B-3224	-	M-32241	19,100	51,200	3,300	-	-	-	-	-
-	-	-	-	-	-	57,900	136,000	6,000	-	IRB 2628
B-3228	-	M-32281	21,900	61,300	3,300	-	-	-	-	-
BH-3312	-	-	10,400	19,500	4,100	36,400	62,100	6,000	-	-
BH-3316	-	MH-33161	14,400	29,900	4,100	50,600	94,700	6,000	IR-2916	-
BH-3324	-	MH-33241	21,800	50,700	4,100	73,900	154,000	6,000	IR-2724, IR-2824	-
B-348	-	-	5,870	11,500	3,100	16,100	26,600	5,500	-	-
B-3416	-	M-34161	13,300	33,000	3,100	38,700	82,500	5,500	-	IRB 3016
B-3420	-	-	16,500	43,700	3,100	-	-	-	-	-
B-3424	-	M-34241	19,600	54,400	3,100	57,900	138,000	5,500	IR-3024	IRB 3024
-	-	-	7,960	14,800	5,600	28,500	56,700	5,000	-	-
B-3612	-	M-36121	10,700	23,700	3,000	-	-	-	-	-
-	-	-	10,400	20,800	5,600	39,300	85,700	5,000	-	-
B-3620	-	-	17,400	46,400	3,000	49,400	115,000	5,000	-	-
B-3624	-	M-36241	20,700	57,700	3,000	58,800	144,000	5,000	-	-
B-4216	-	M-42161	15,000	40,900	2,500	42,000	97,900	4,000	-	IRB 3616
B-4410	-	-	9,210	22,000	2,500	25,000	50,800	3,500	-	-
-	-	-	8,150	16,400	4,500	31,500	68,700	3,500	-	-
B-4416	-	-	15,500	42,800	2,500	43,500	104,000	3,500	IR-4016	IRB 4016
B-4420	-	M-44201	19,200	56,700	2,500	54,600	139,000	3,500	-	IRB 4020
B-5612	-	-	14,600	33,700	2,700	-	-	-	-	-
B-8812	-	-	17,300	52,000	1,600	-	-	-	-	-

(1) JT, JTT는 그리스 주입시 허용회전수이며, 그 외에는 오일주입시 허용회전수입니다.